

INTER-PLUS

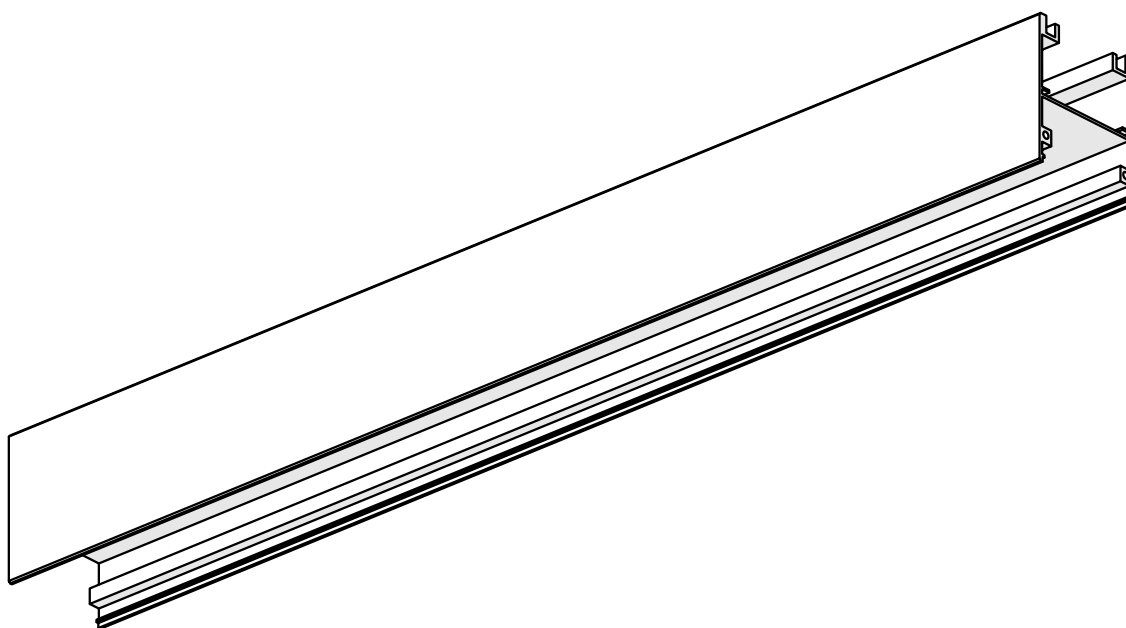

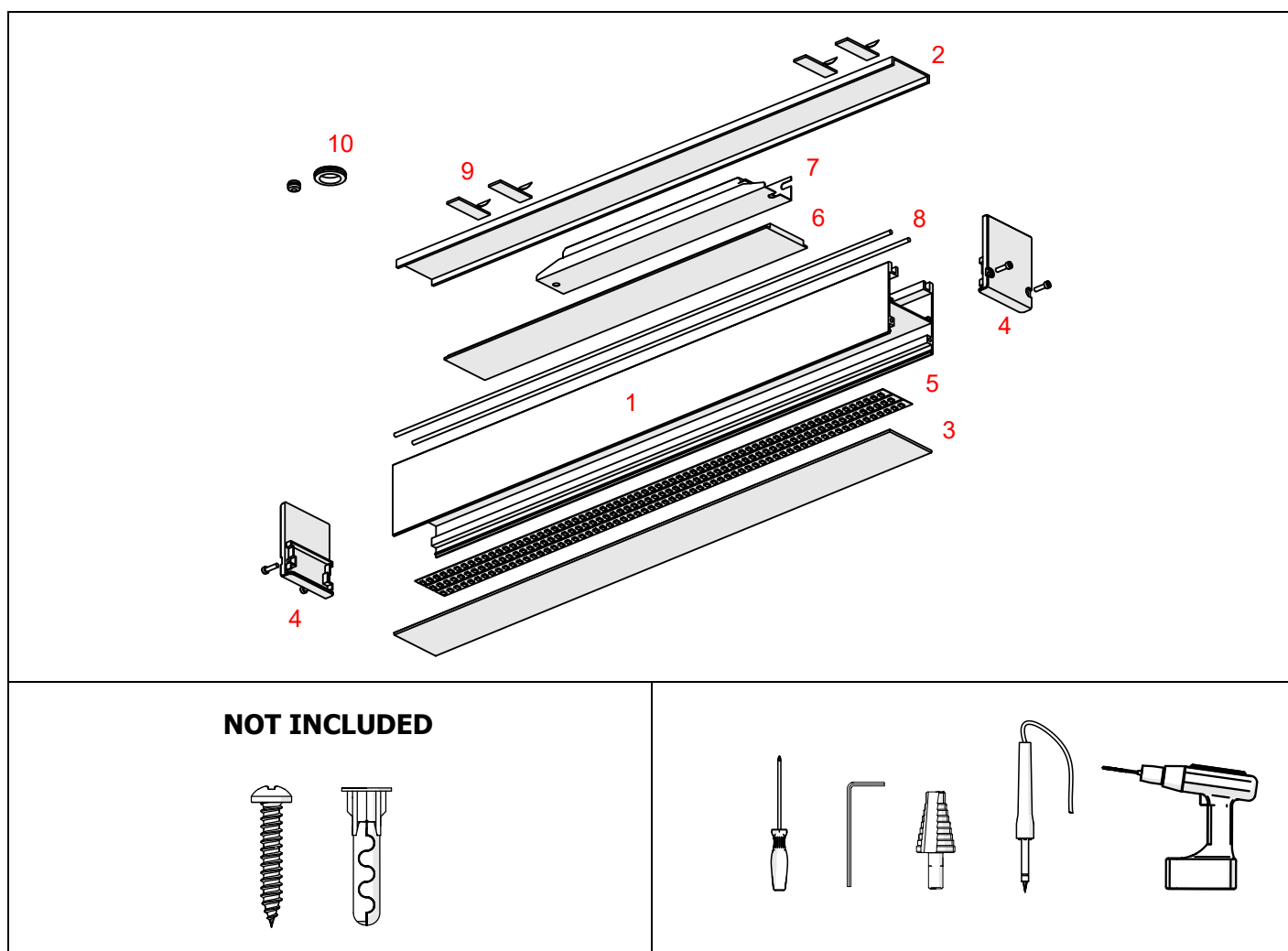

1. Profile INTER-PLUS (Ref. A18078)
2. Profile BOX-Z*
3. Cover HSP-47 (Ref. B17181)
4. End cap INTER-PLUS (Ref. C24570)
5. LED tape*
6. Mounting pad 45 (Ref. Z70457)
7. Power supply*
8. Plastic rod dia. 4 mm *
9. Spacers*
10. Gland*

* The full range of accessories and electronics is available at www.KlusDesign.eu

NOTE! ! All LED tapes must be connected to a 24 V power supply.

IMPORTANT: Not all possible mounting procedures are presented here.
More mounting procedures and related accessories can be found at www.KlusDesign.eu.
Drawings in these instructions are simplified and only approximate the actual shapes.

I

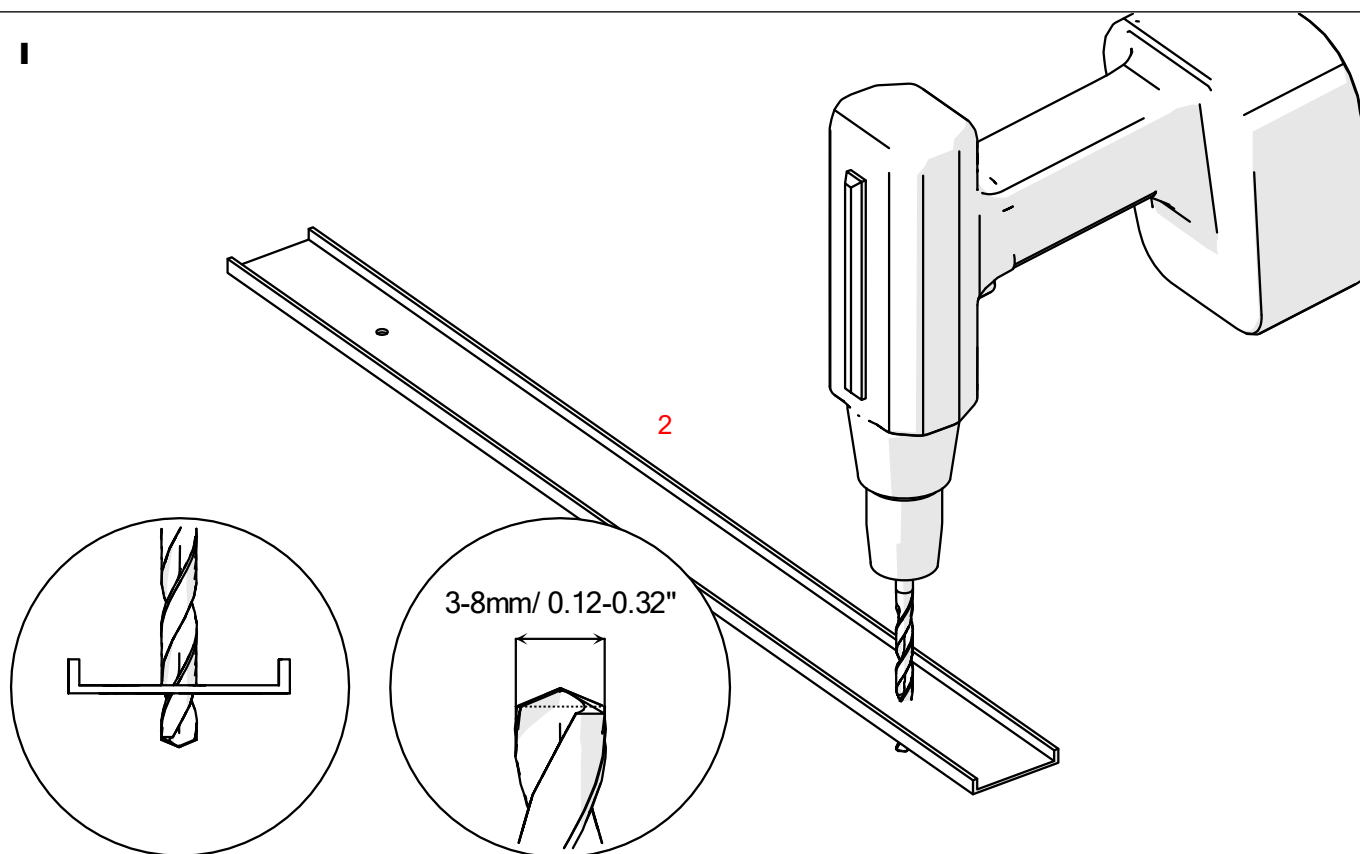

II

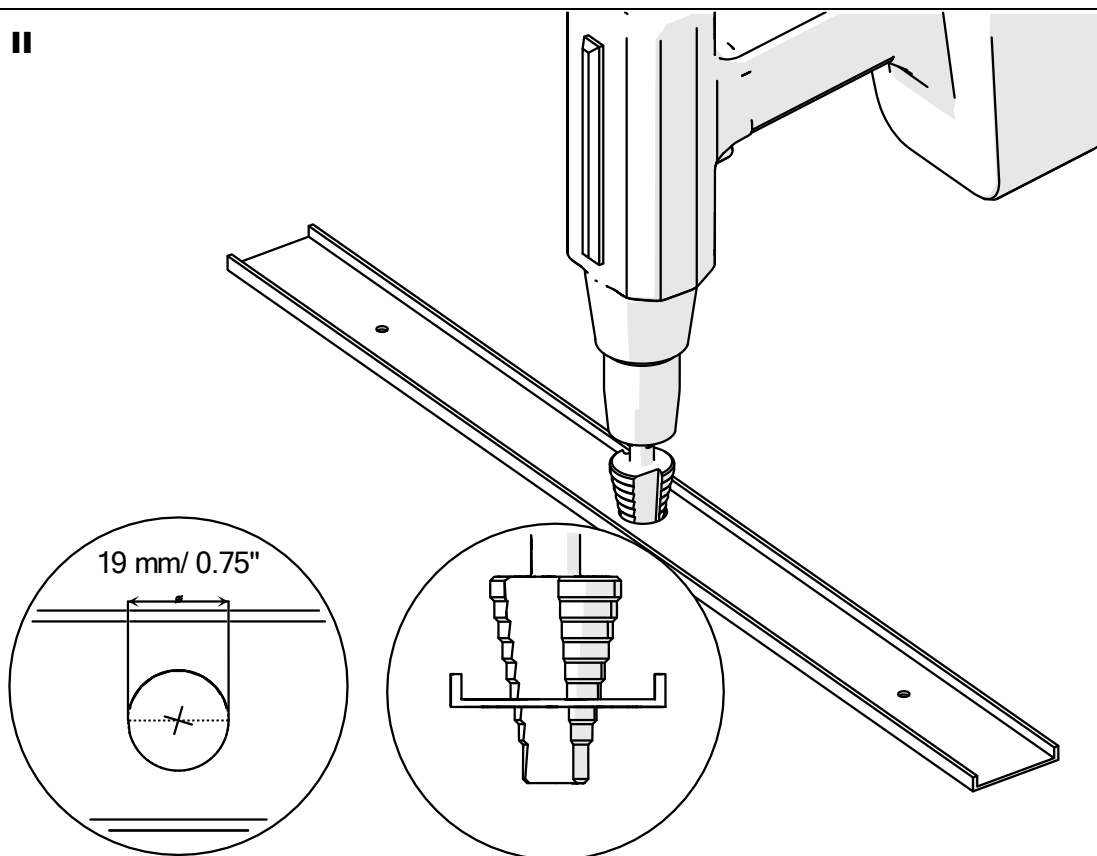

III

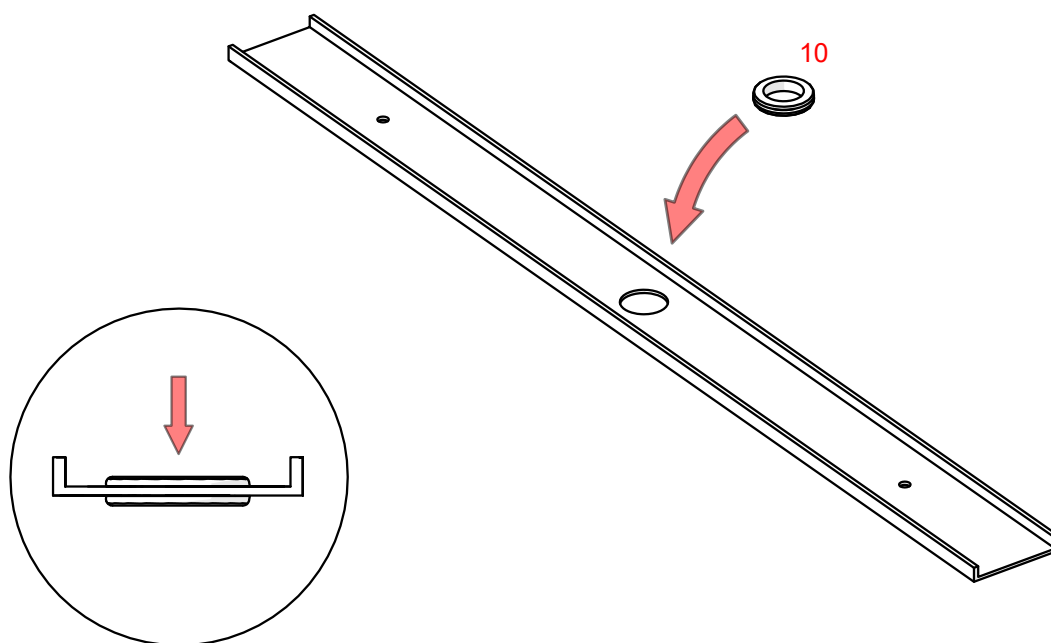

IV

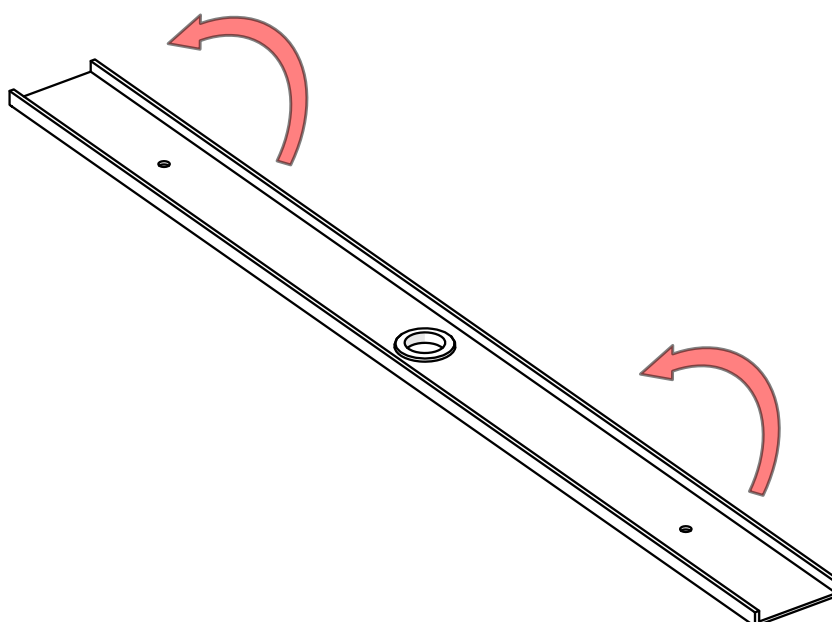

V

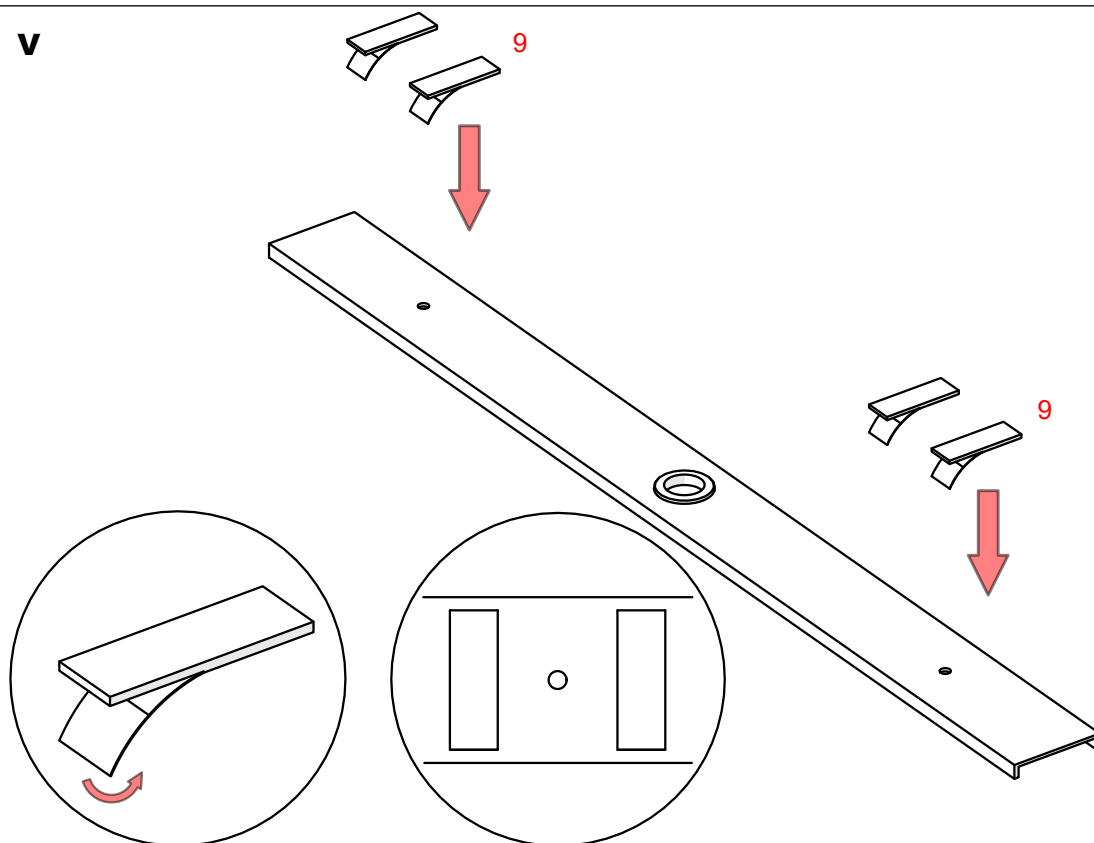

VI

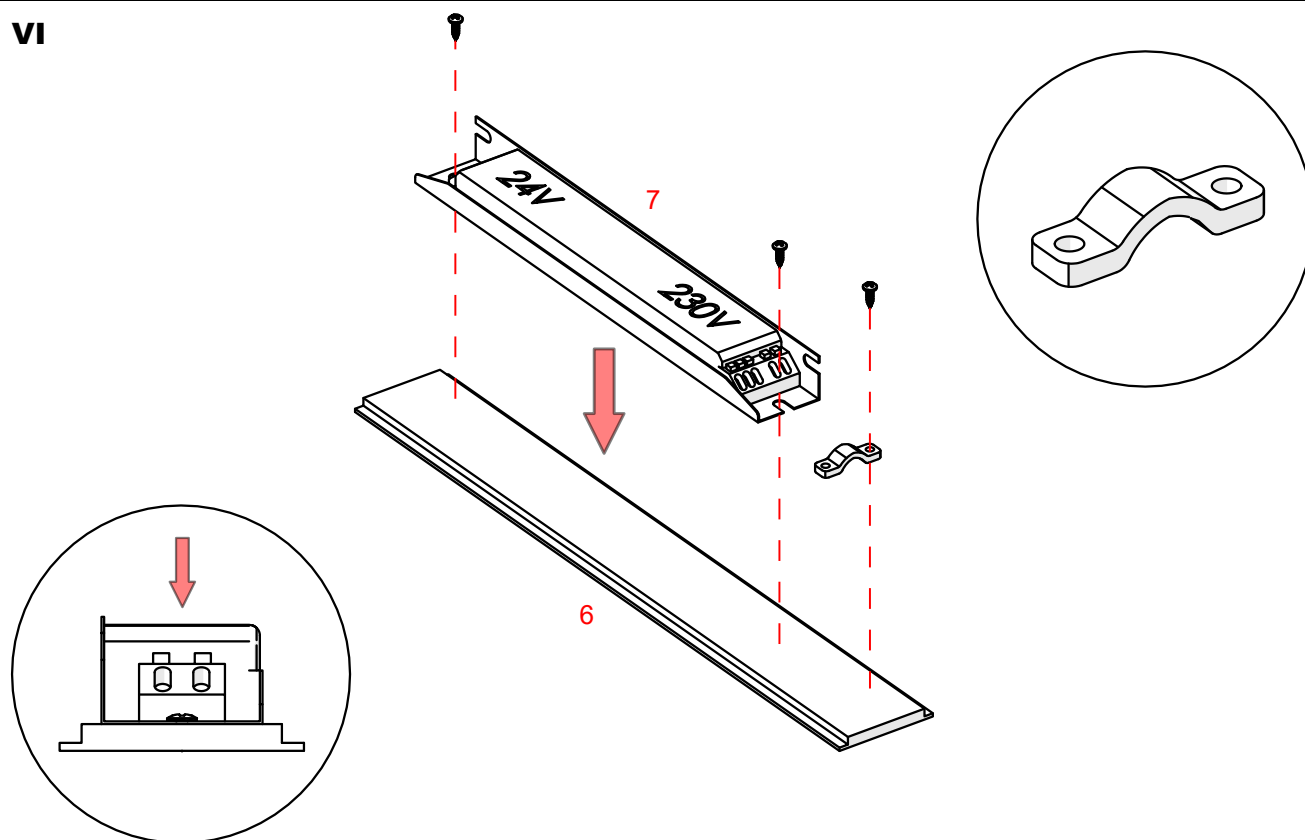

VII

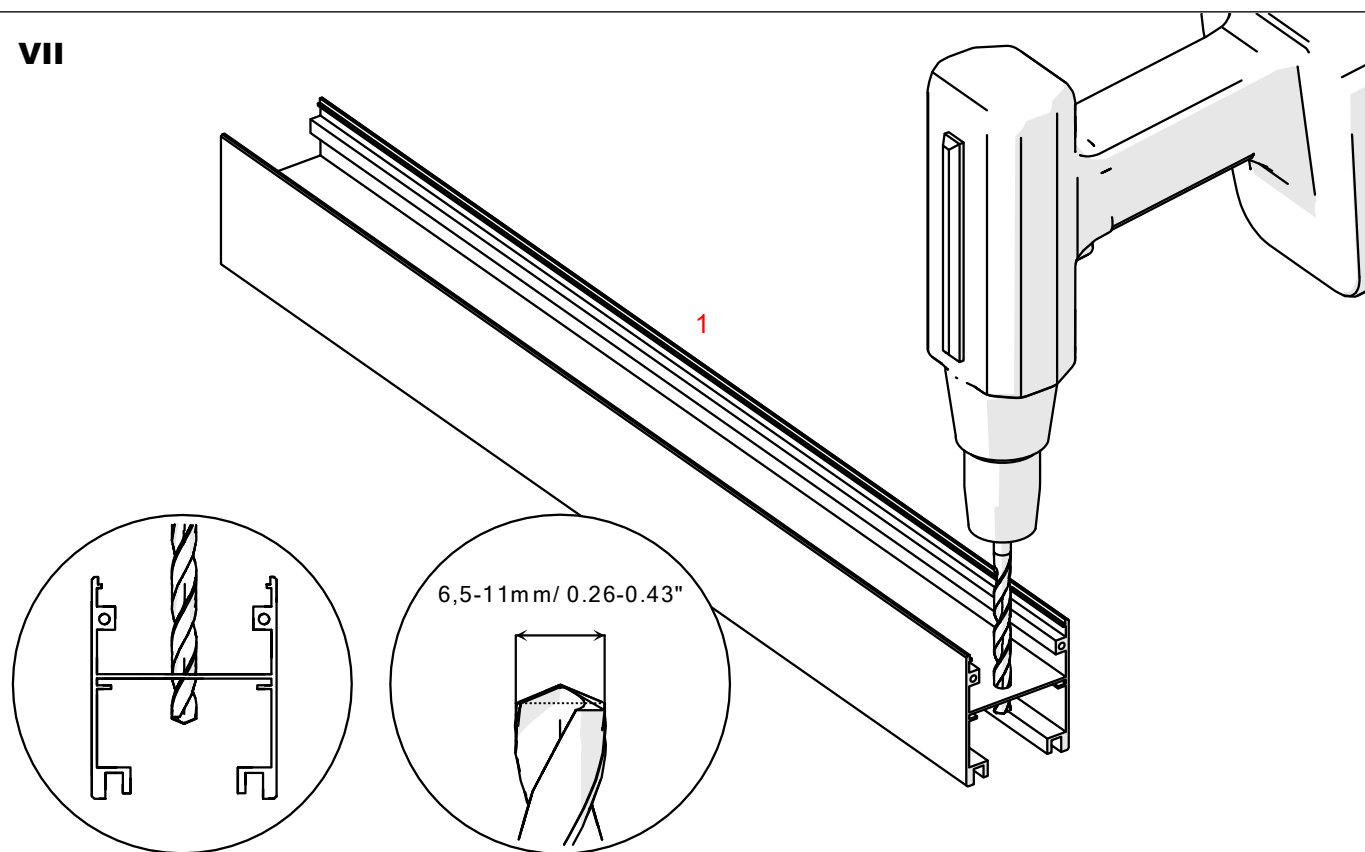

VIII

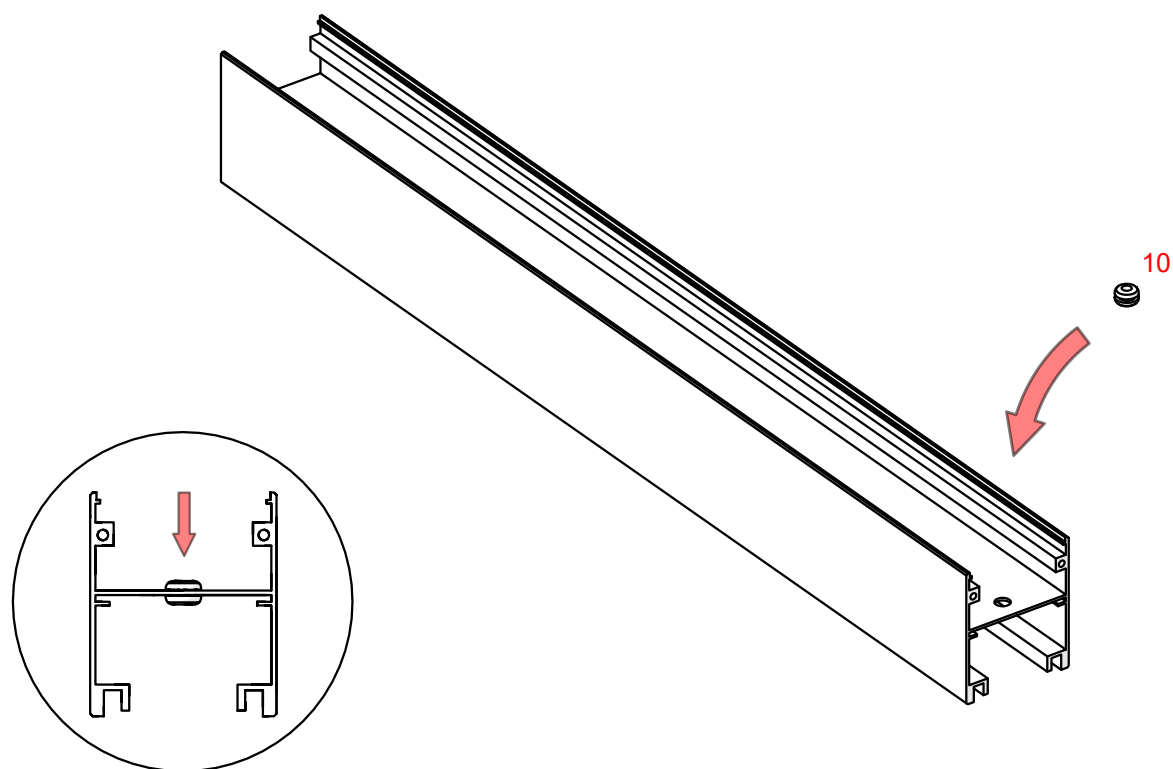

IX

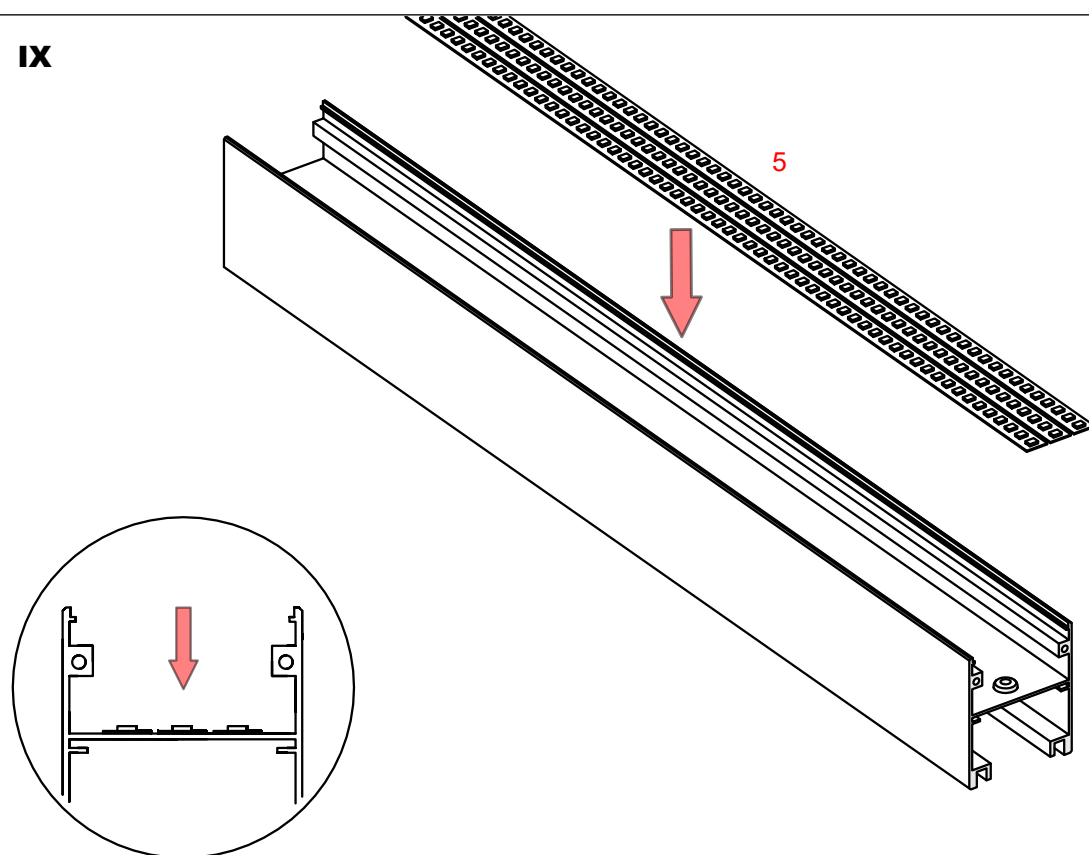

X

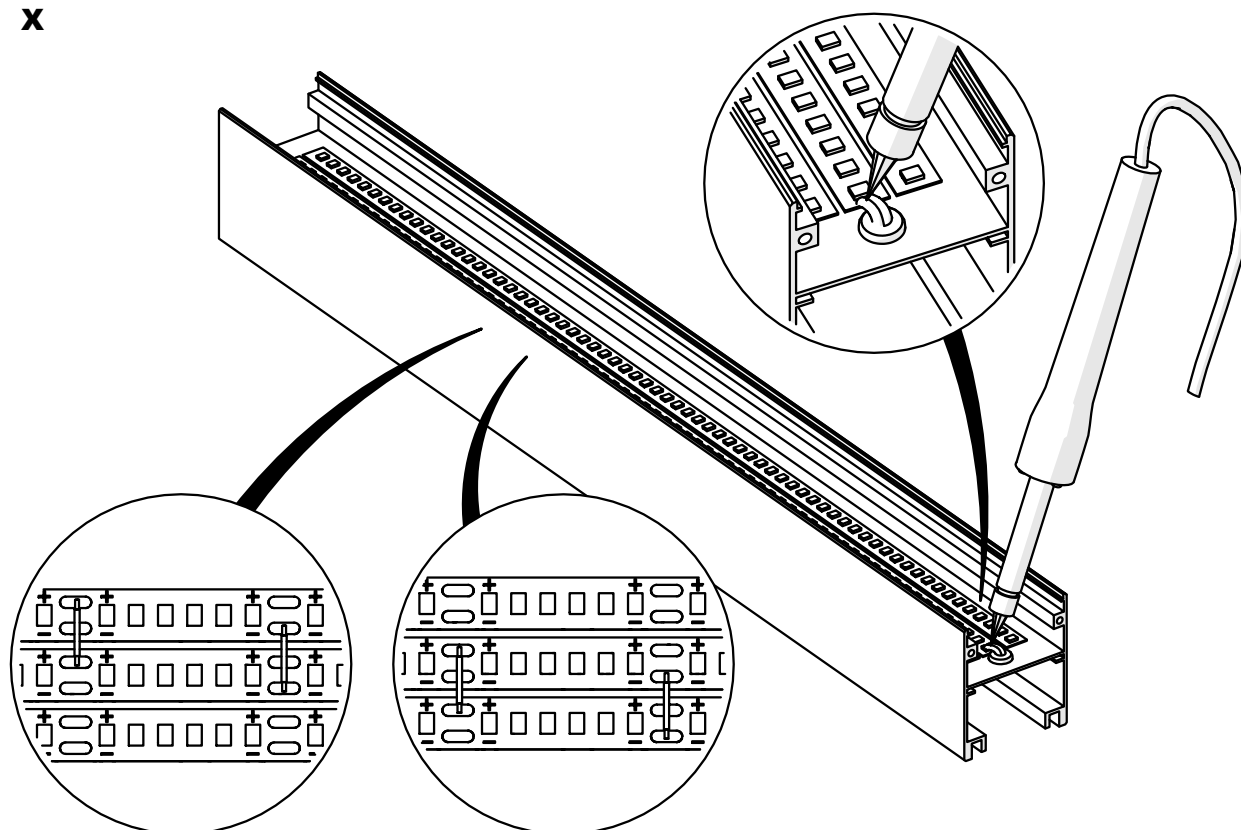

XI

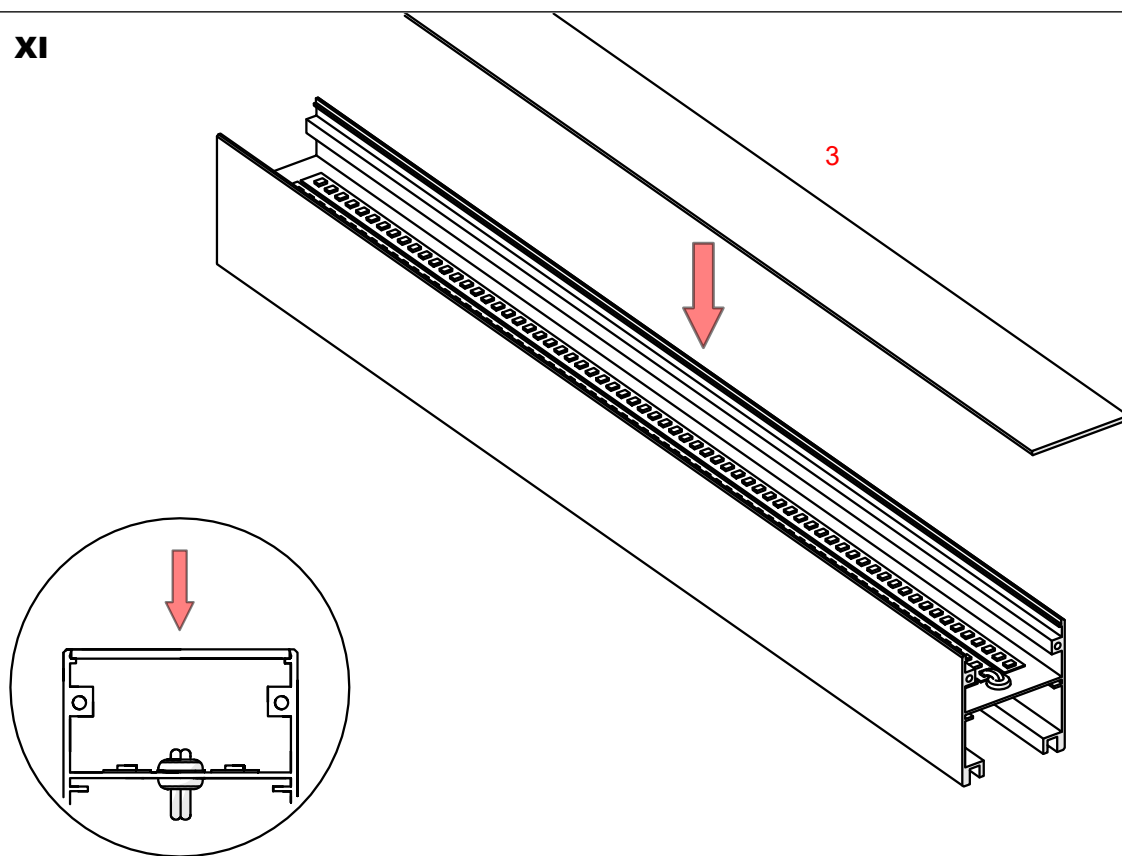

XII

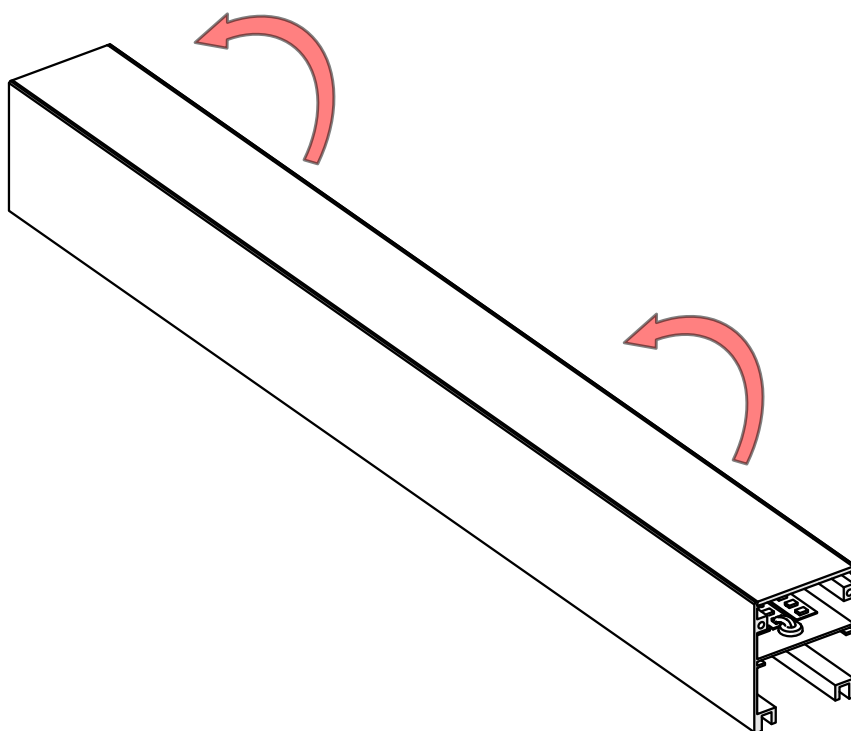

XIII

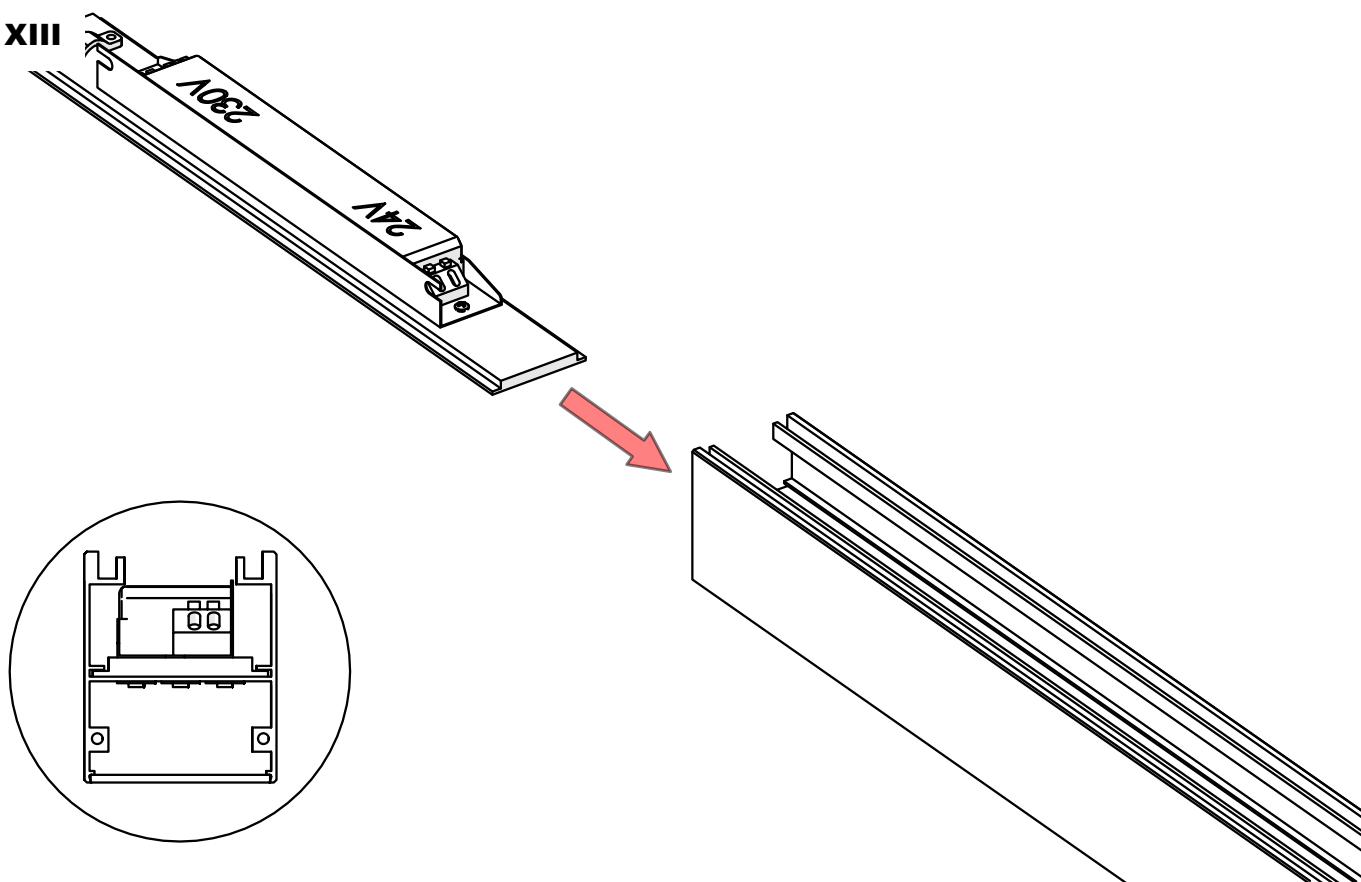

XIV

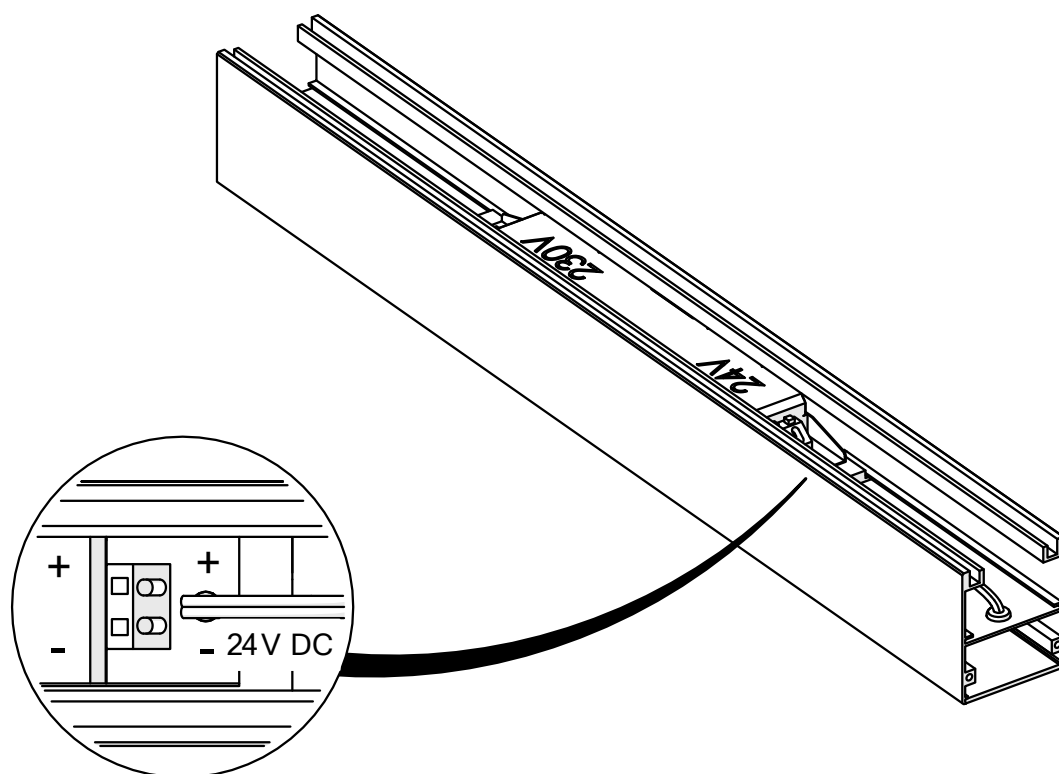

XV



22 0-24 0V AC
50/60 Hz

XVI

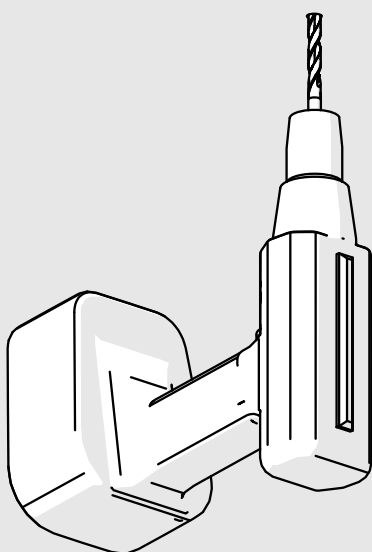

XVII

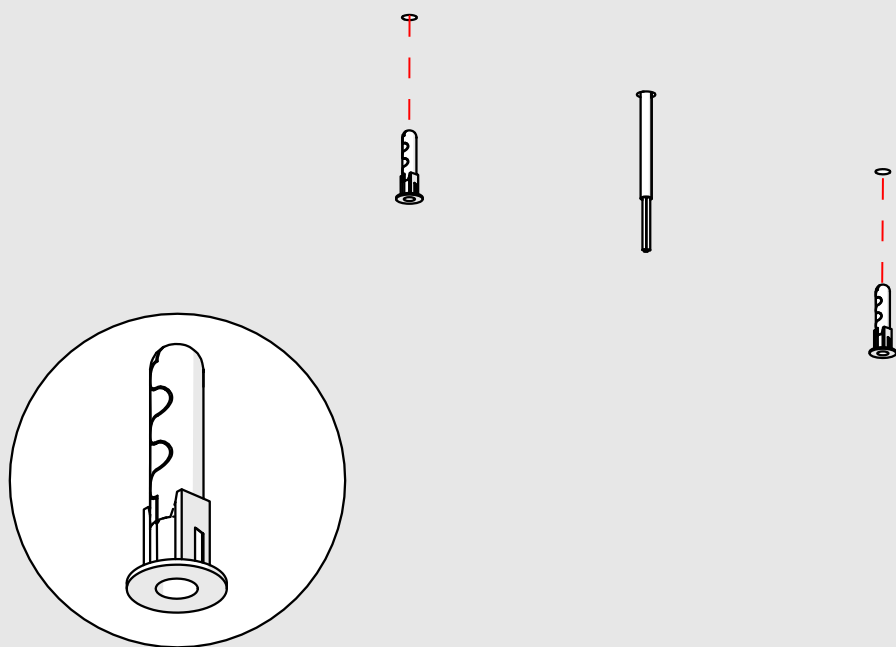

XVIII

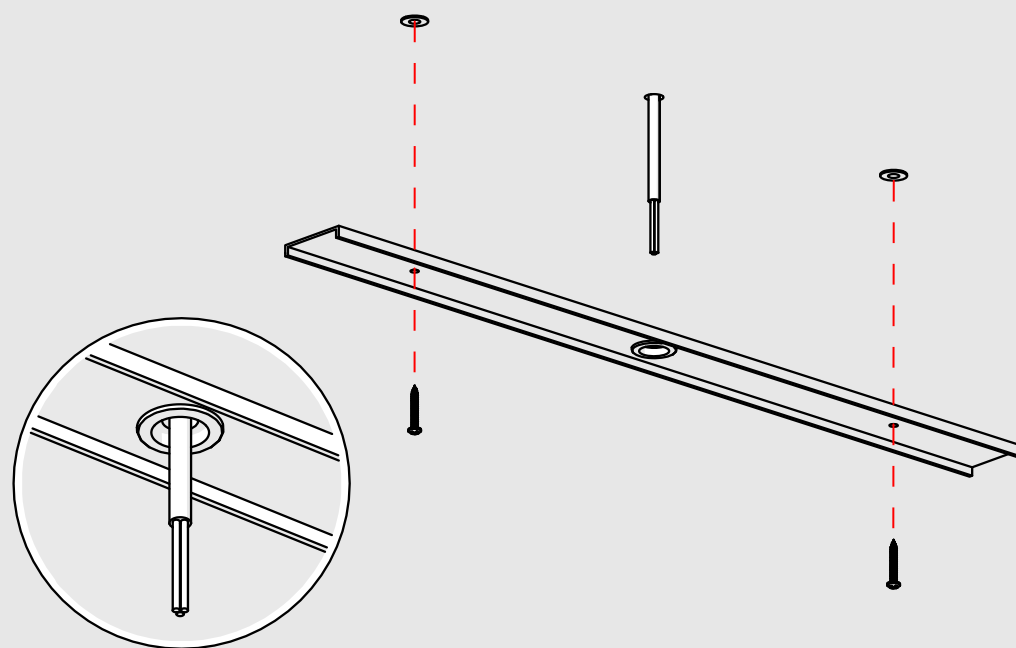

XIX

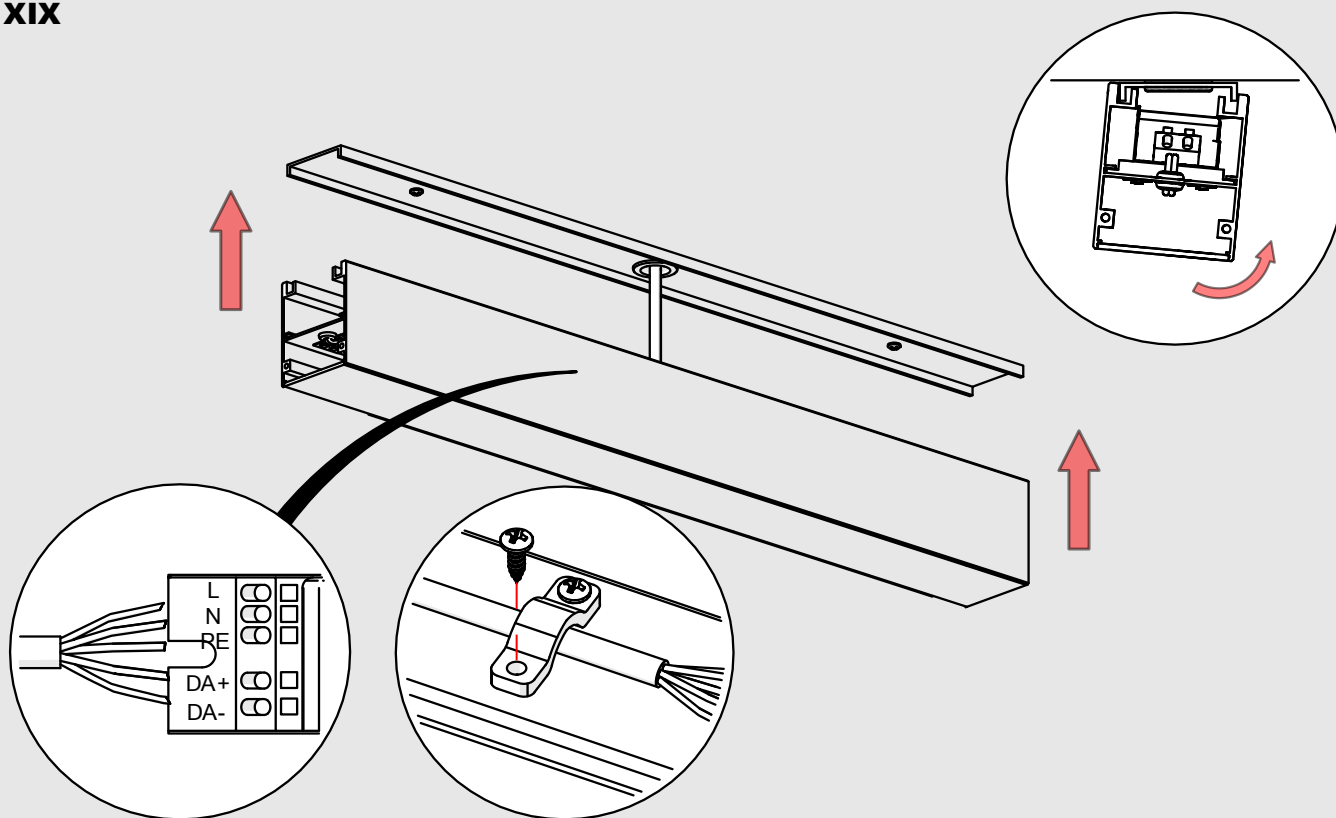

XX

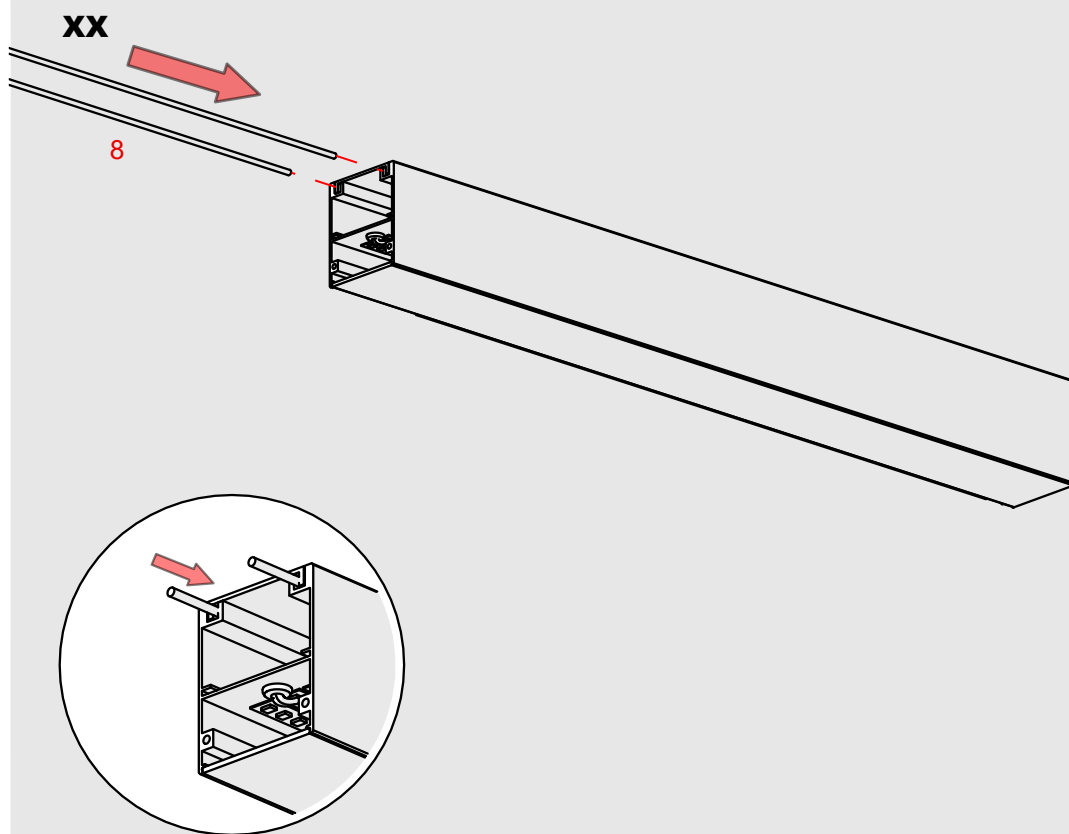

XXI

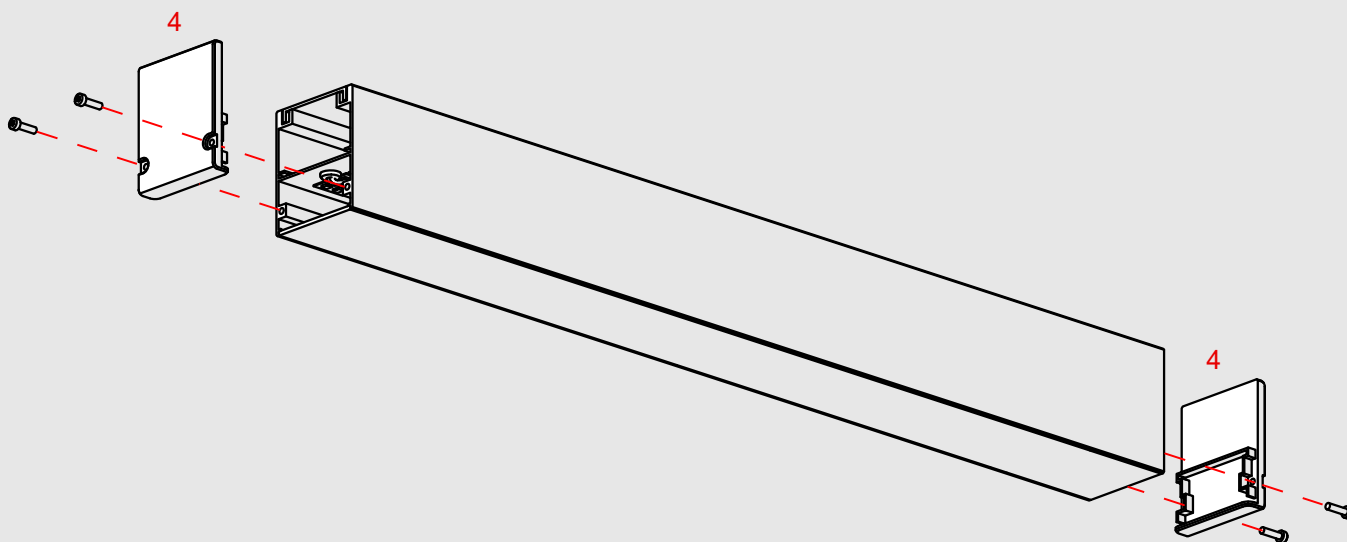

XXII

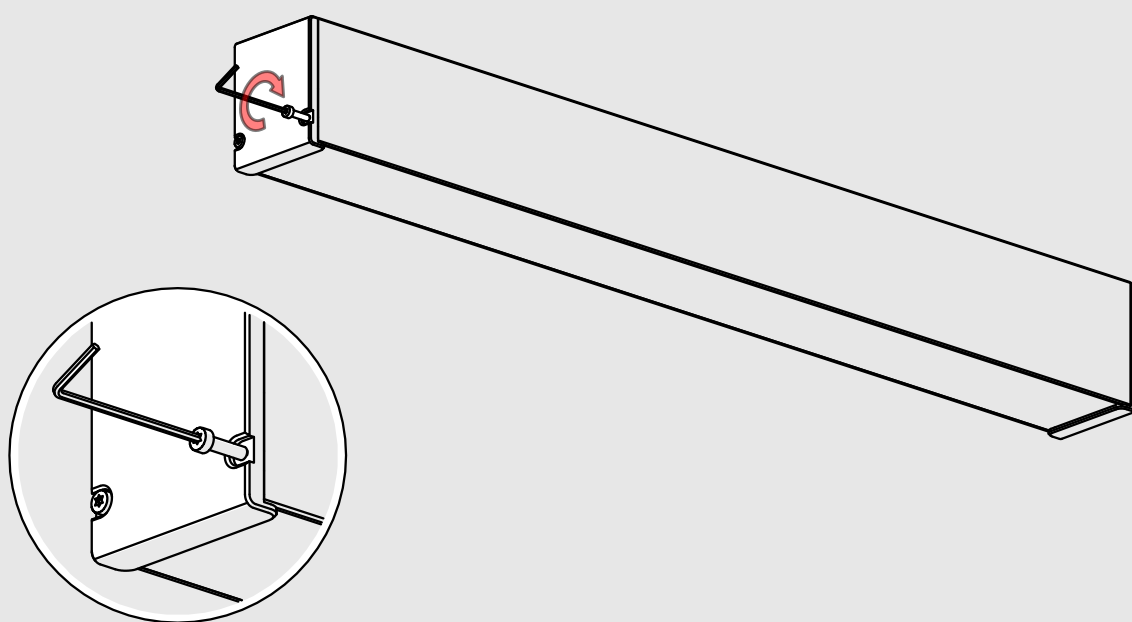

XXIII

