

## INTER-PLUS

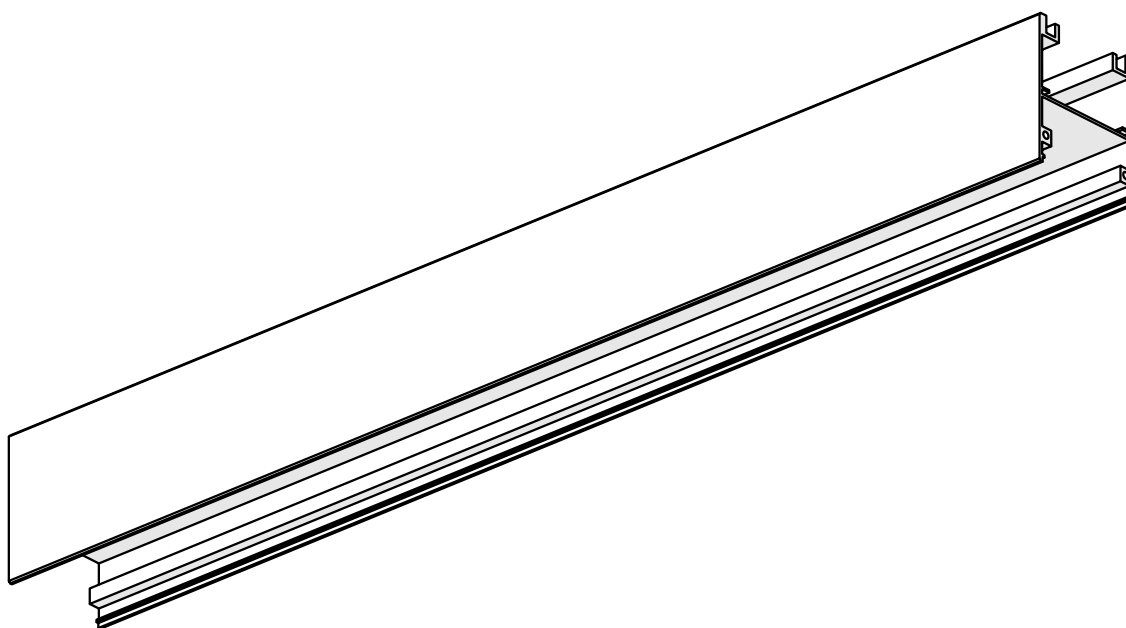

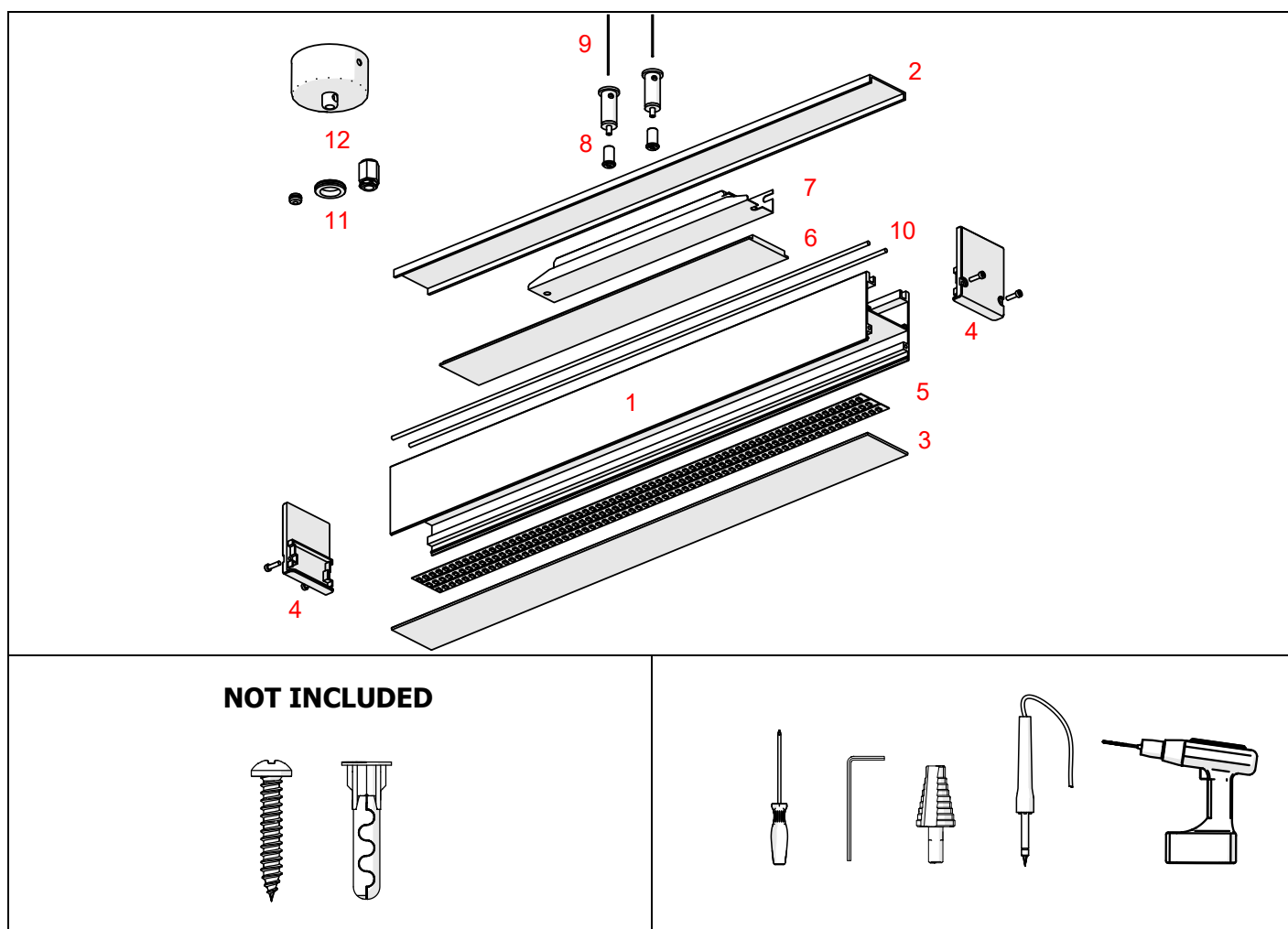

1. Profile INTER-PLUS (Ref. A18078)
2. Profile BOX-Z\*
3. Cover HSP-47 (Ref. B17181)
4. End cap INTER-PLUS (Ref. C24570)
5. LED tape\*
6. Mounting pad 45 (Ref. Z70457)
7. Power supply\*
8. Fastener set\*
9. Steel cable\*
10. Plastic rod dia. 4 mm \*
11. Gland\*
12. Canopy\*

\* The full range of accessories and electronics is available at [www.KlusDesign.eu](http://www.KlusDesign.eu)

**NOTE! !** All LED tapes must be connected to a 24 V power supply.

**IMPORTANT:** Not all possible mounting procedures are presented here.  
More mounting procedures and related accessories can be found at [www.KlusDesign.eu](http://www.KlusDesign.eu).  
Drawings in these instructions are simplified and only approximate the actual shapes.

**I**

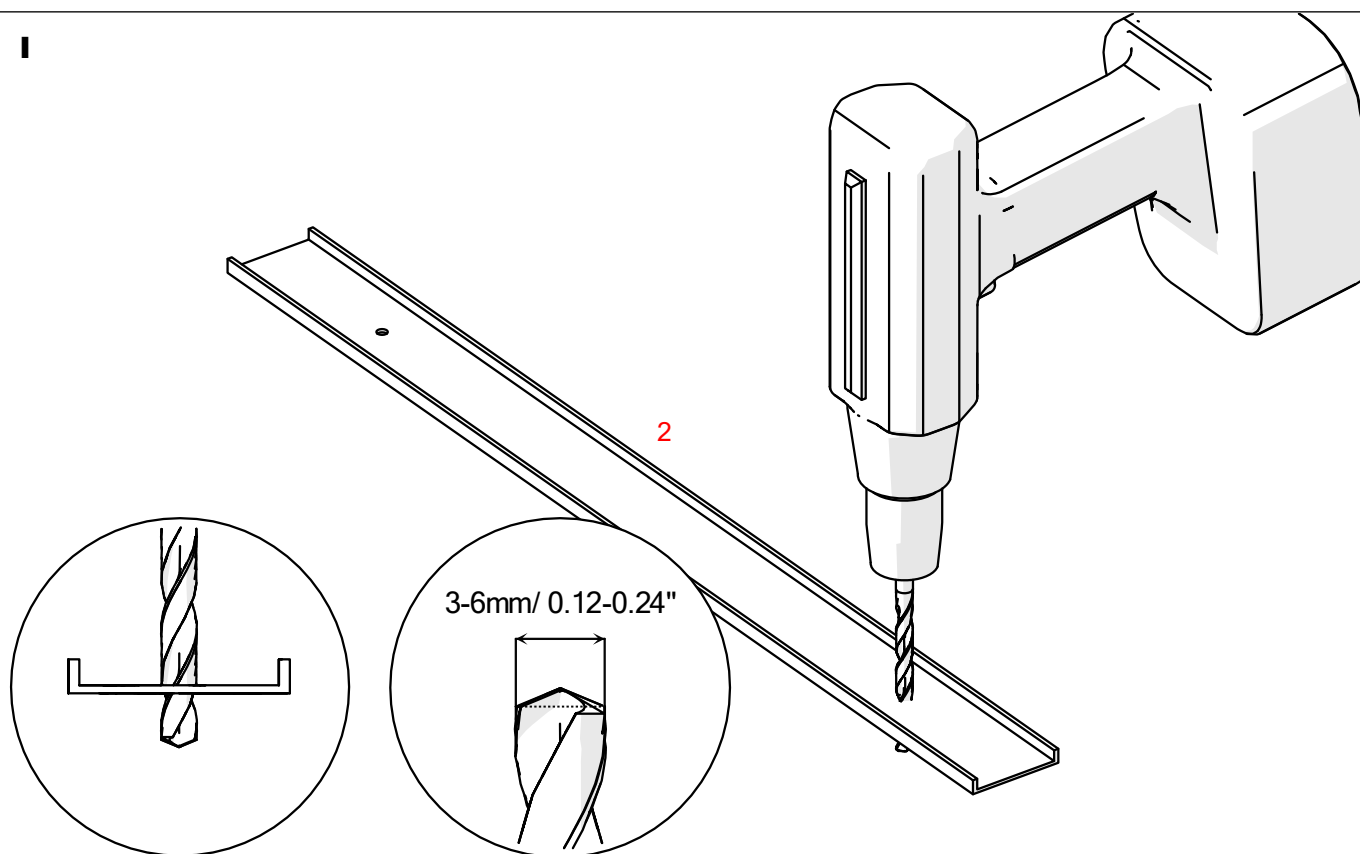

**II**

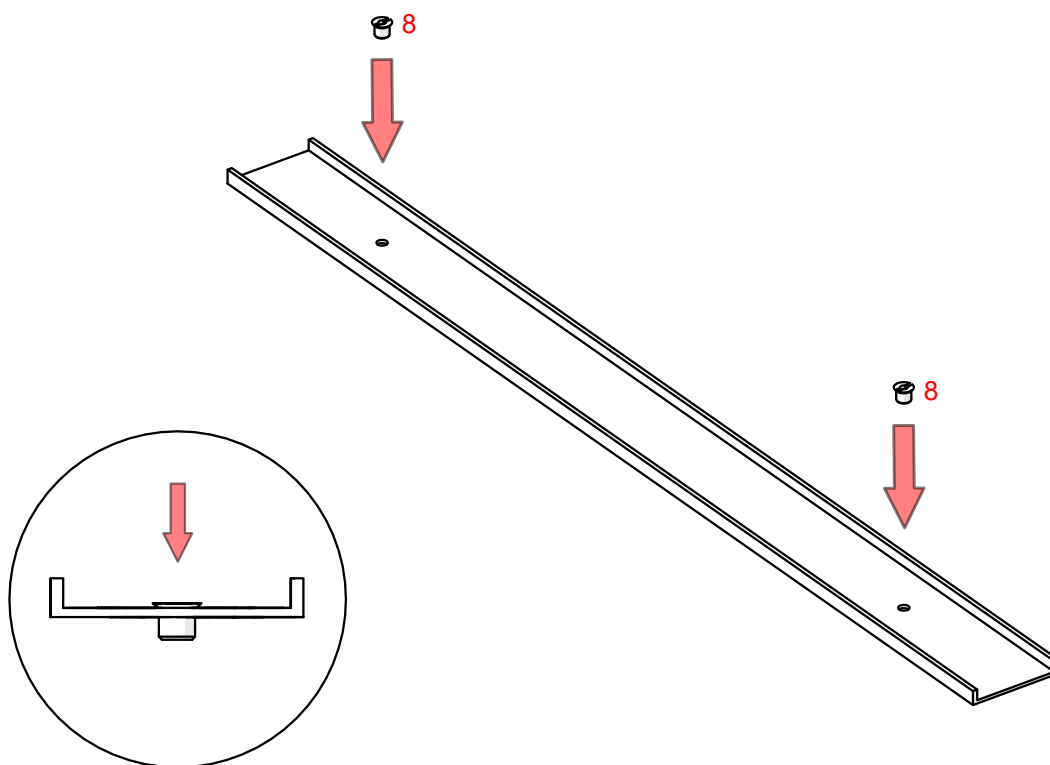

**III**

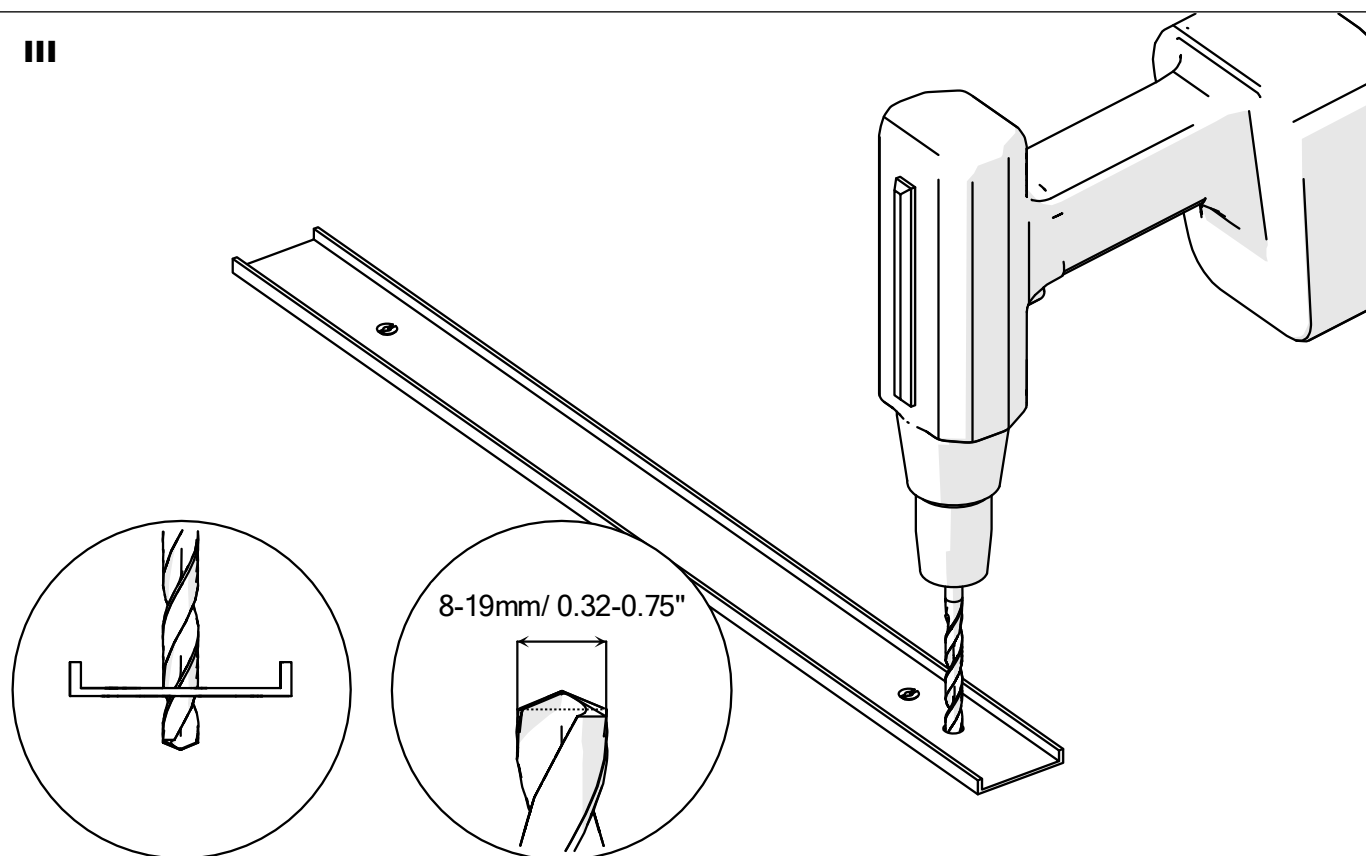

**IV**

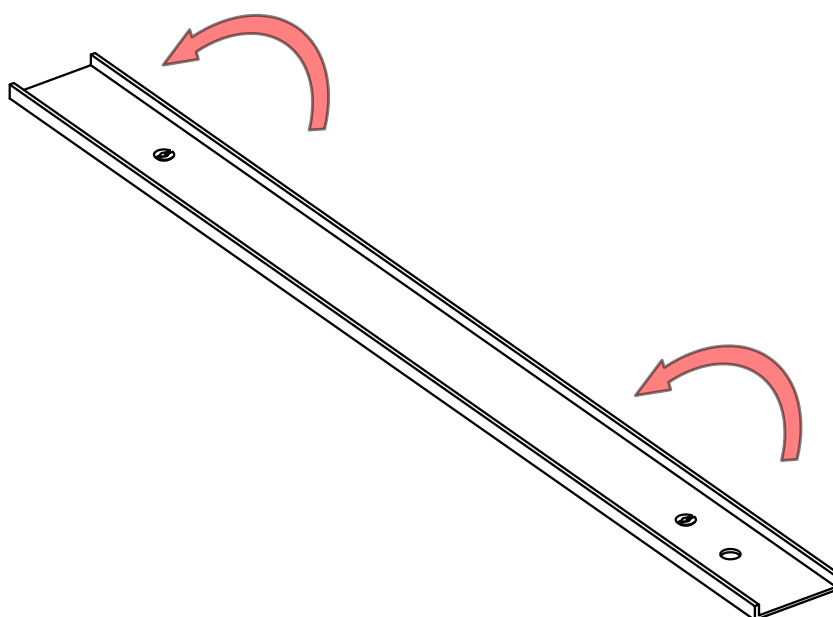

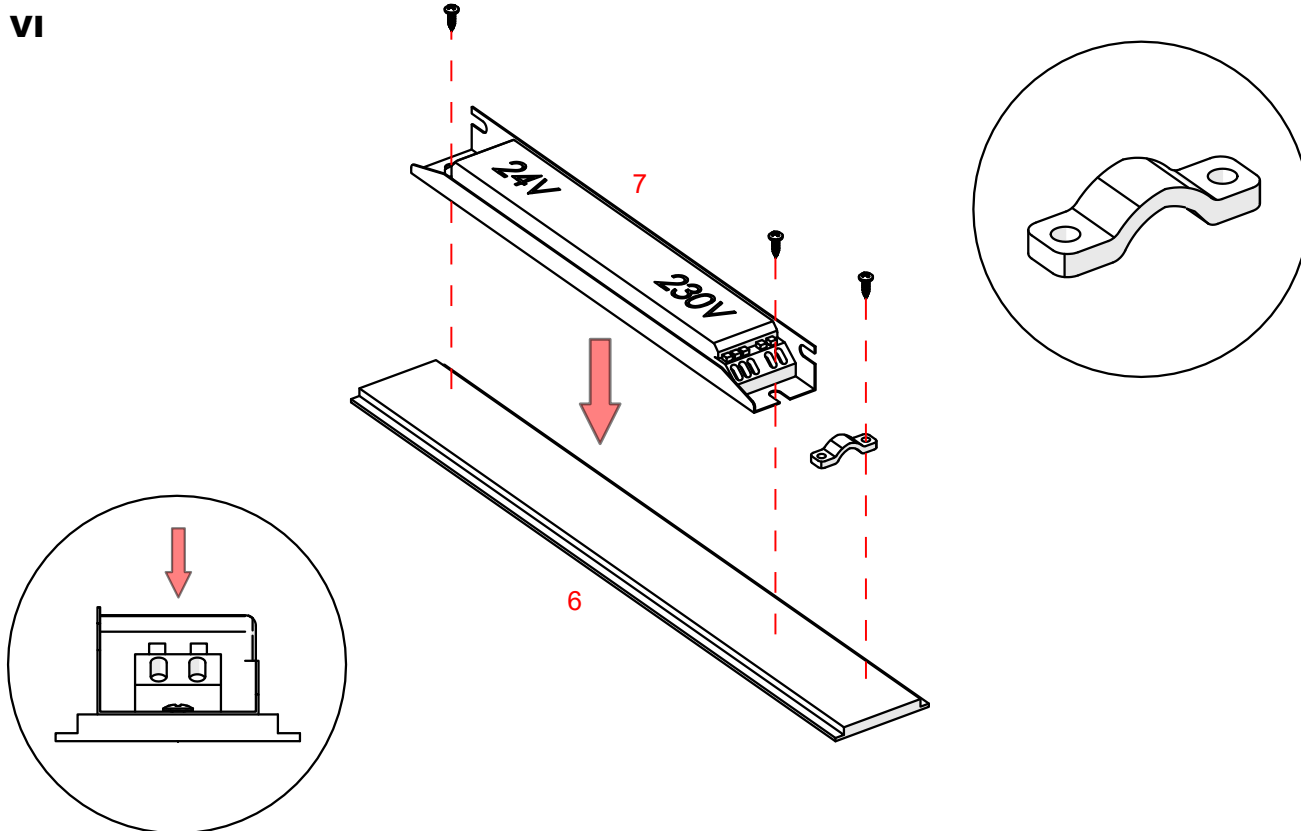
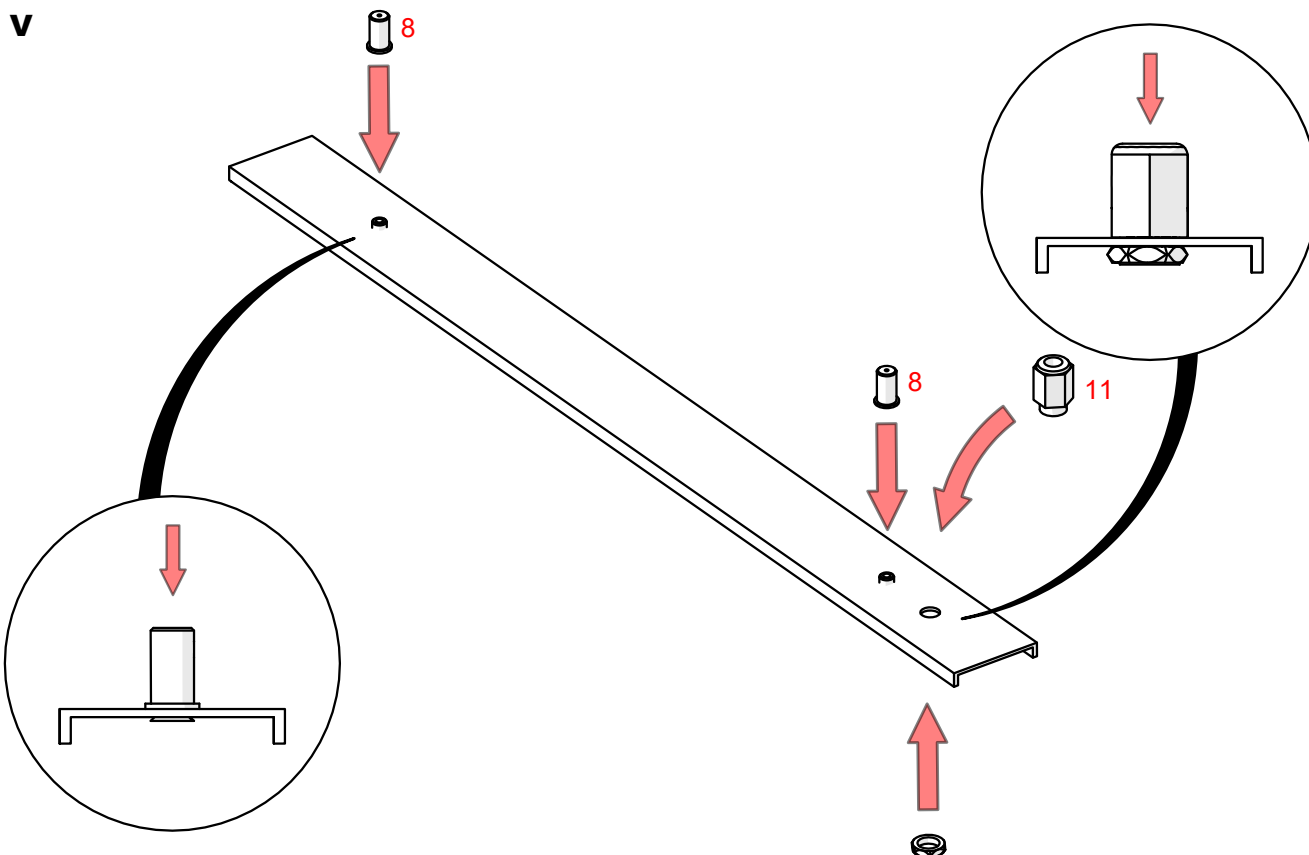

**VII**

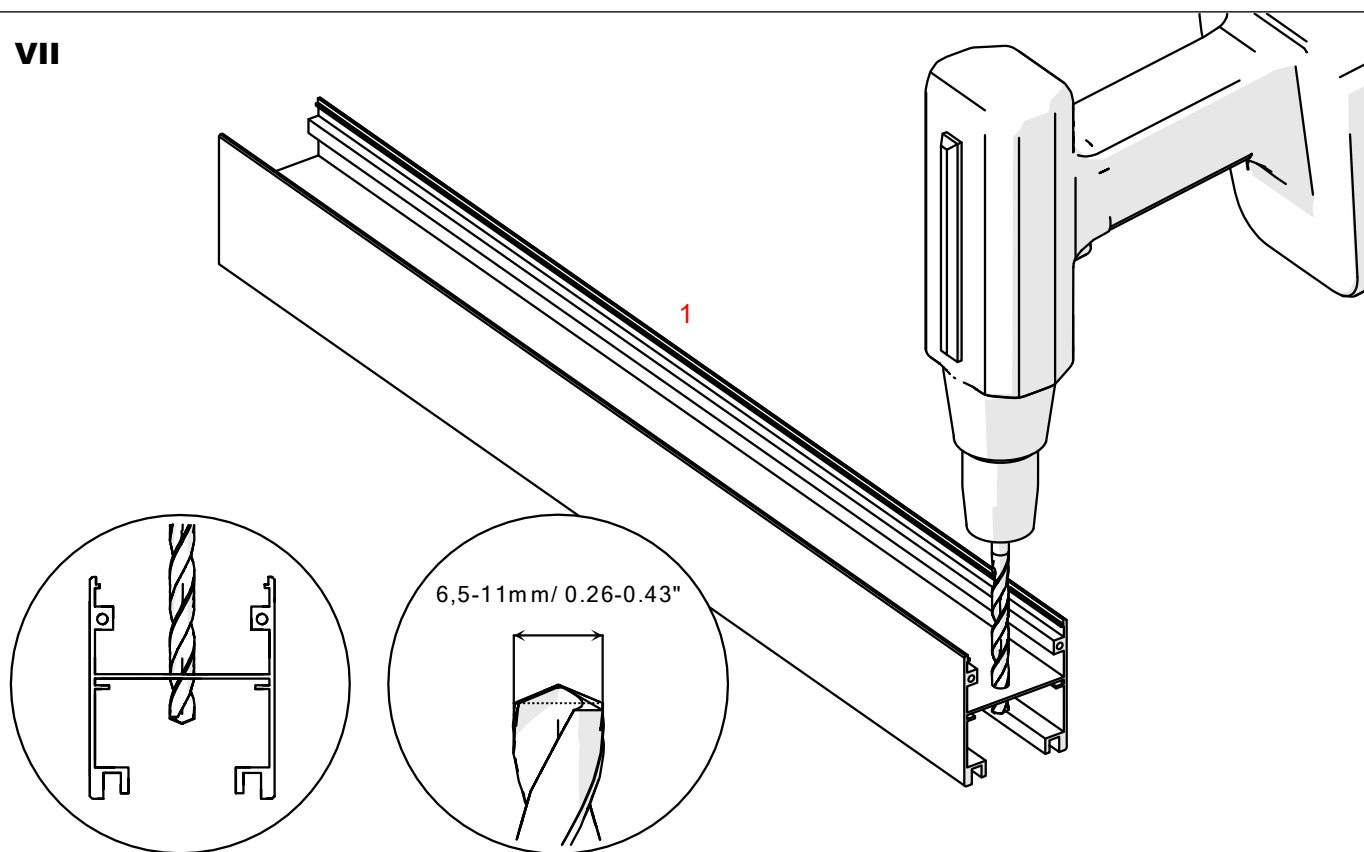

**VIII**

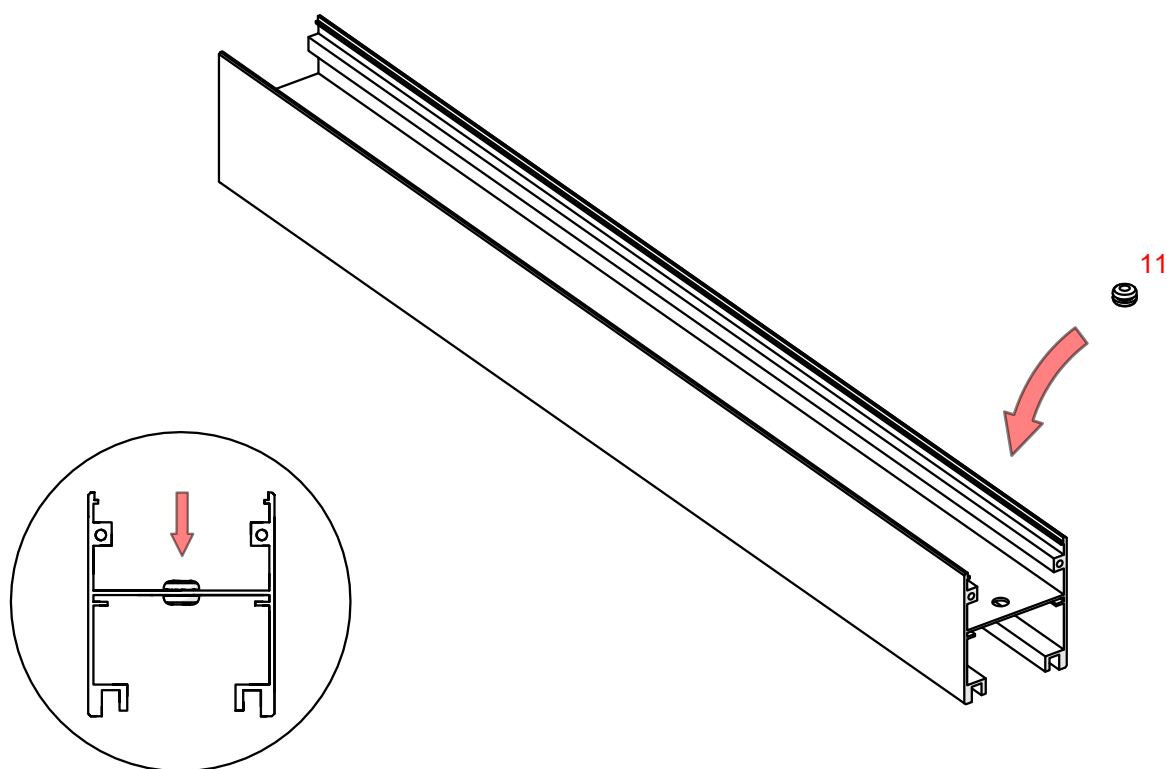

**IX**

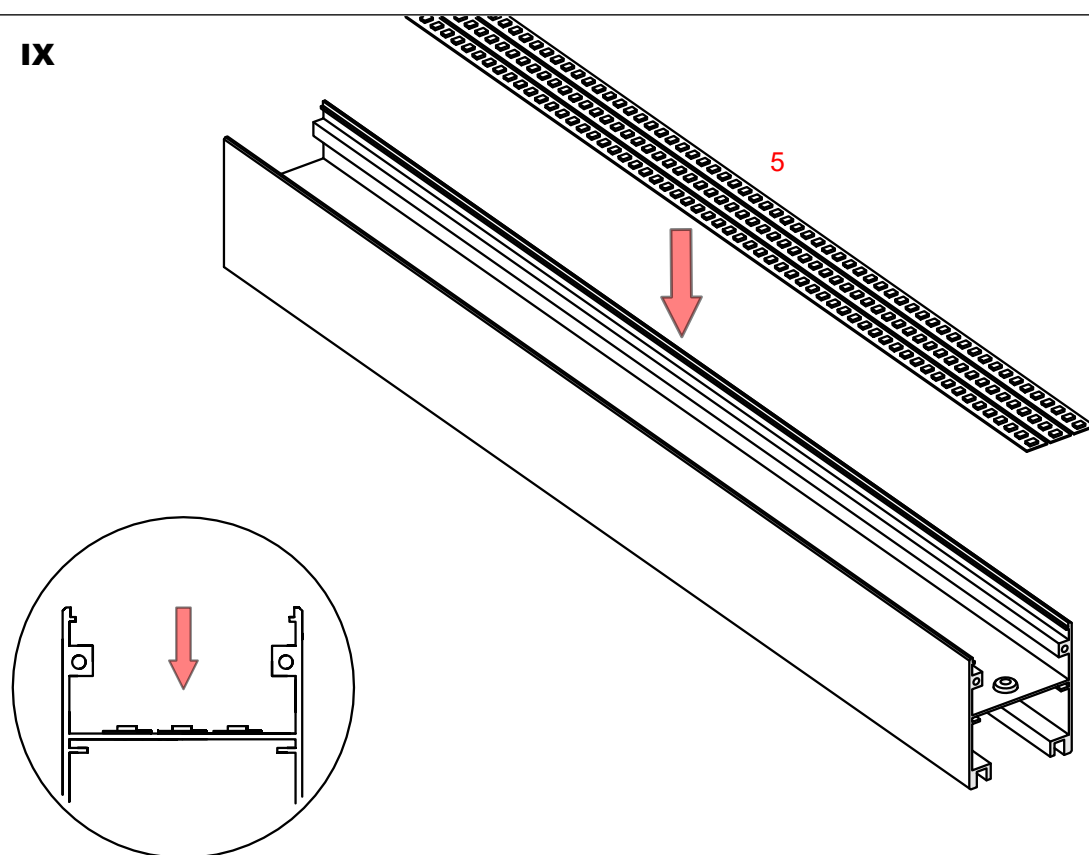

**X**

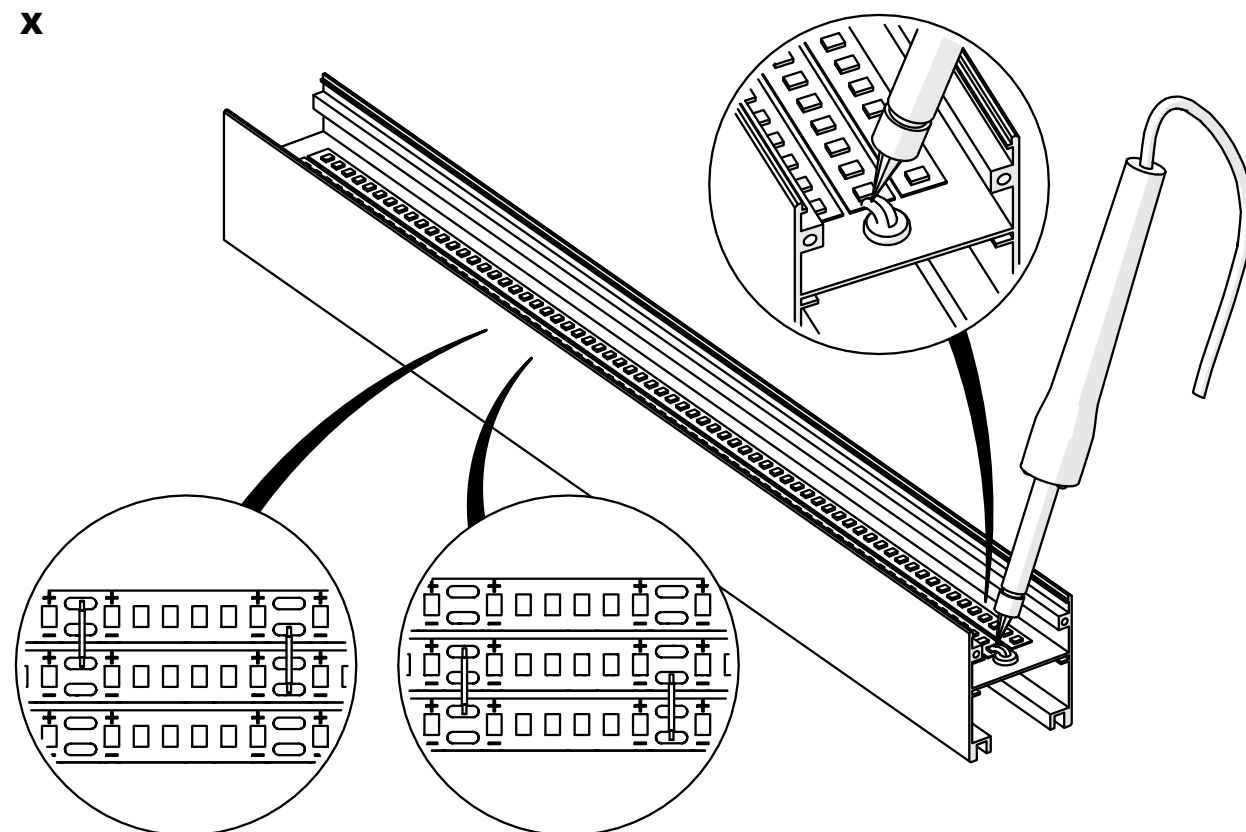

**XI**

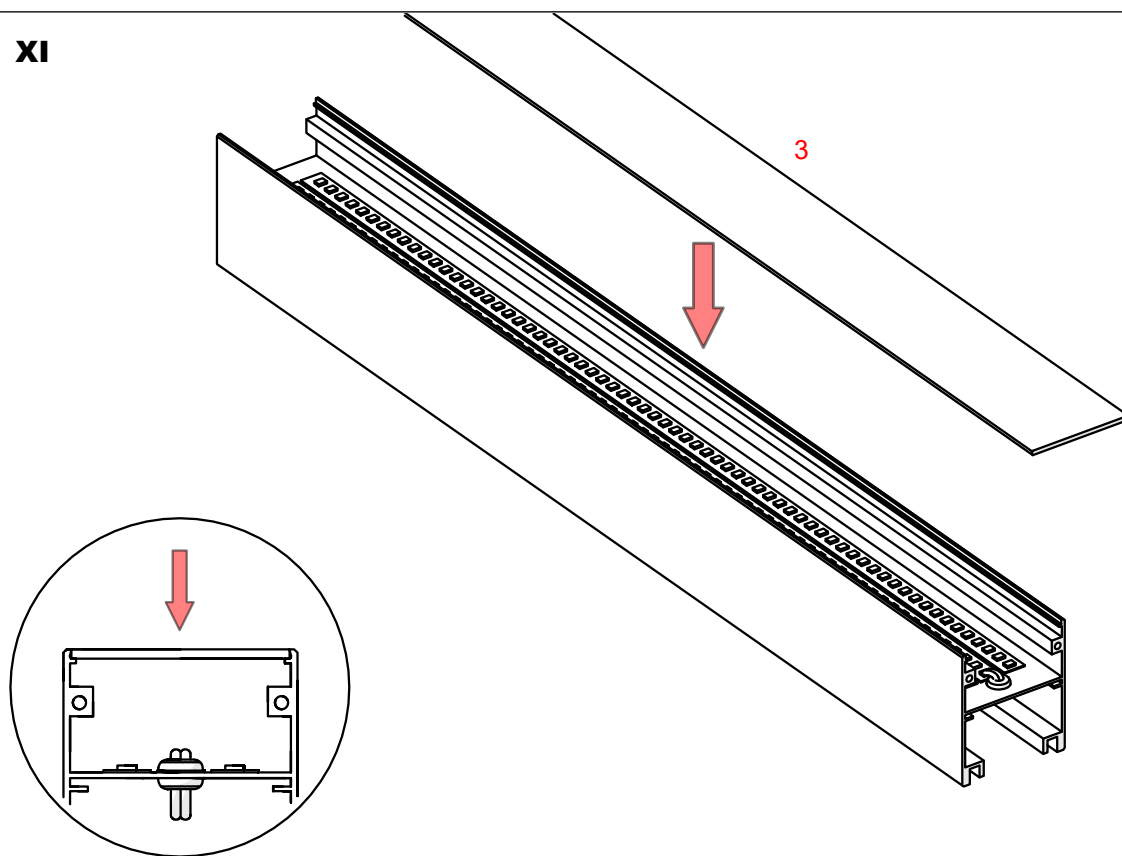

**XII**

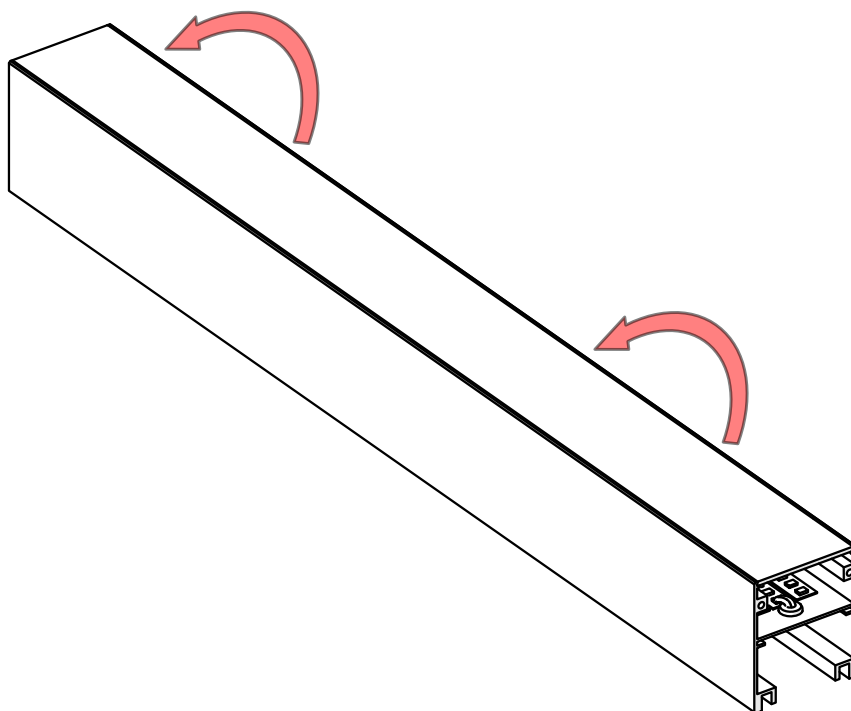



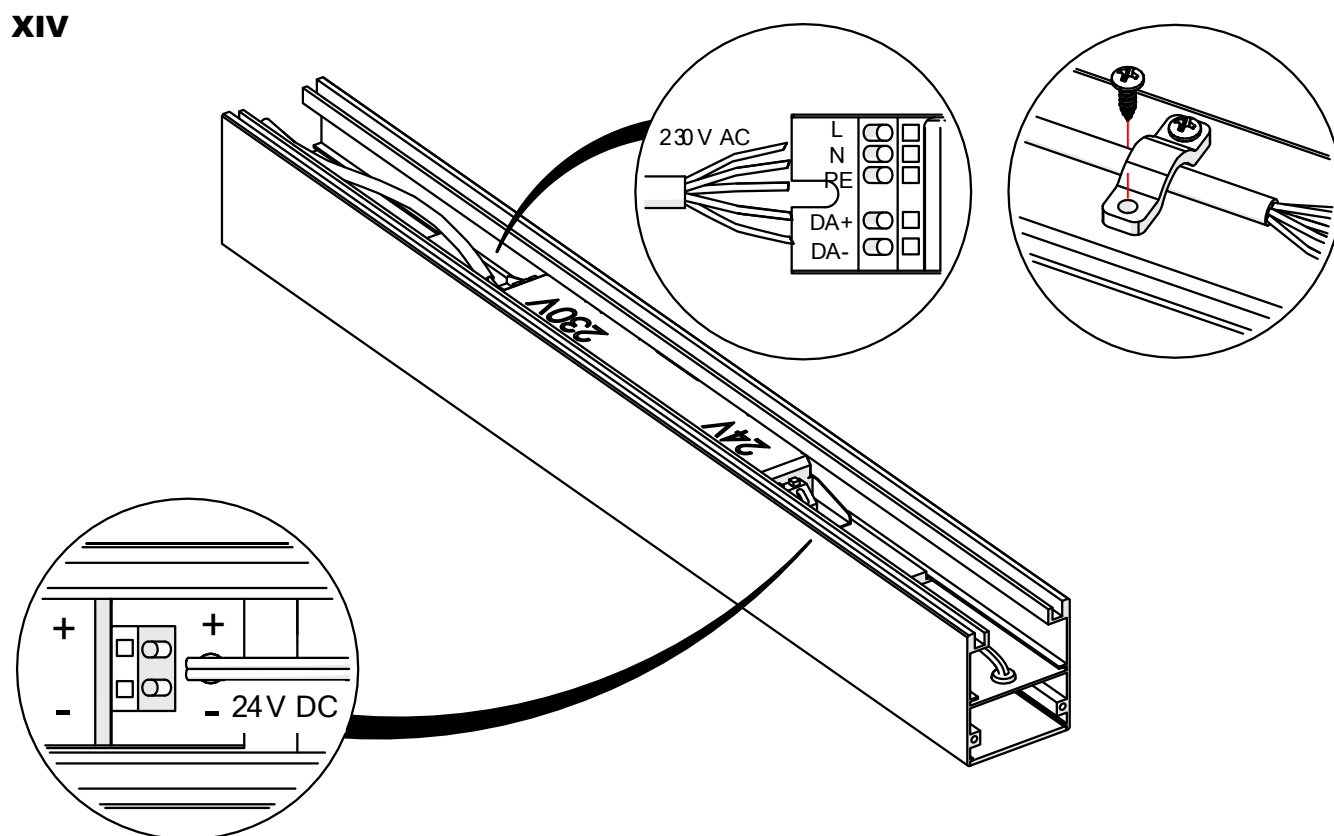
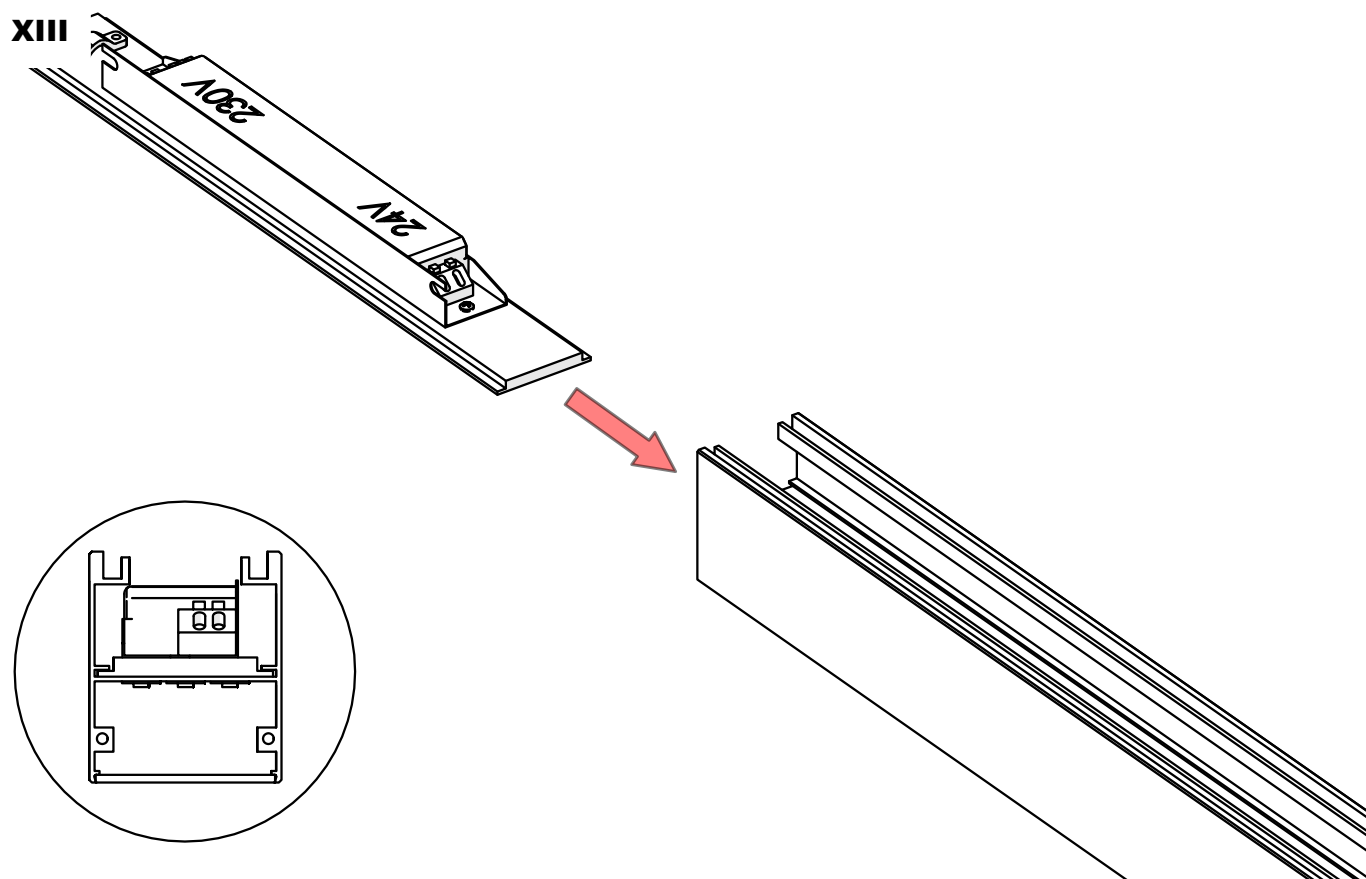

**XV**

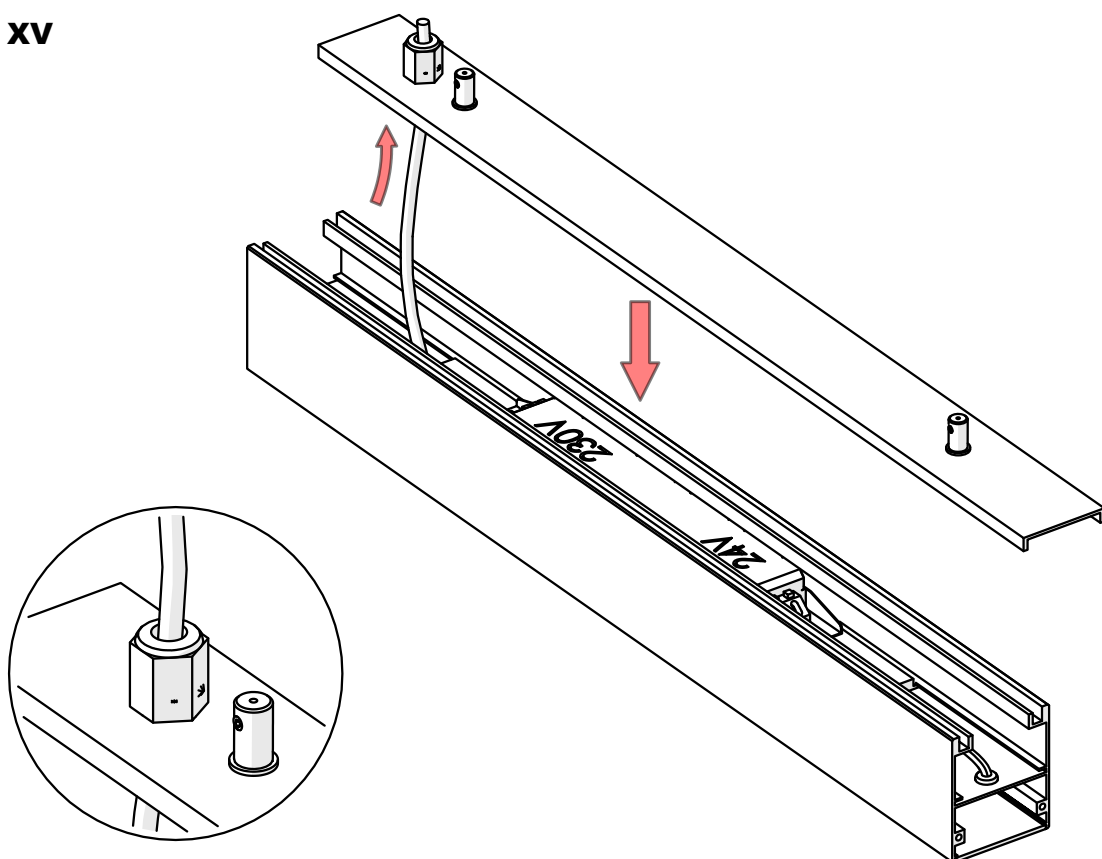

**XVI**

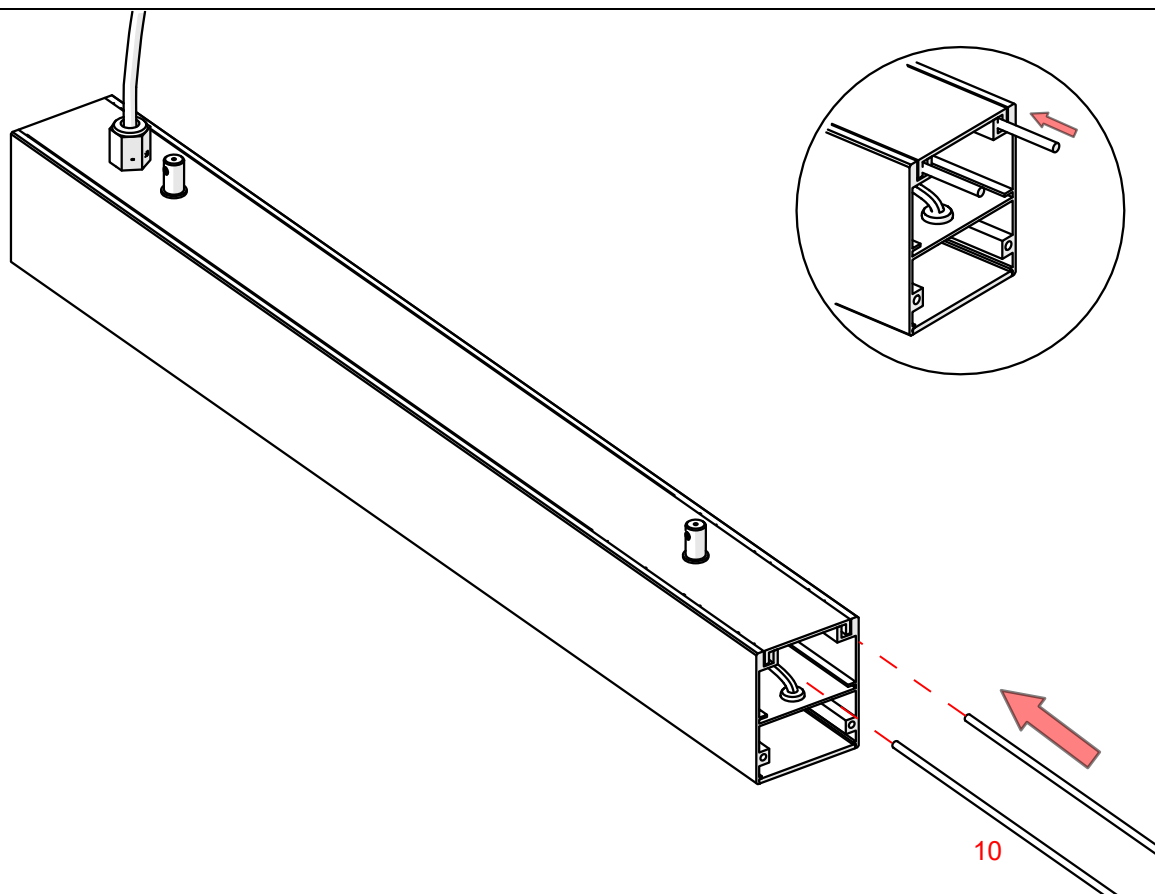

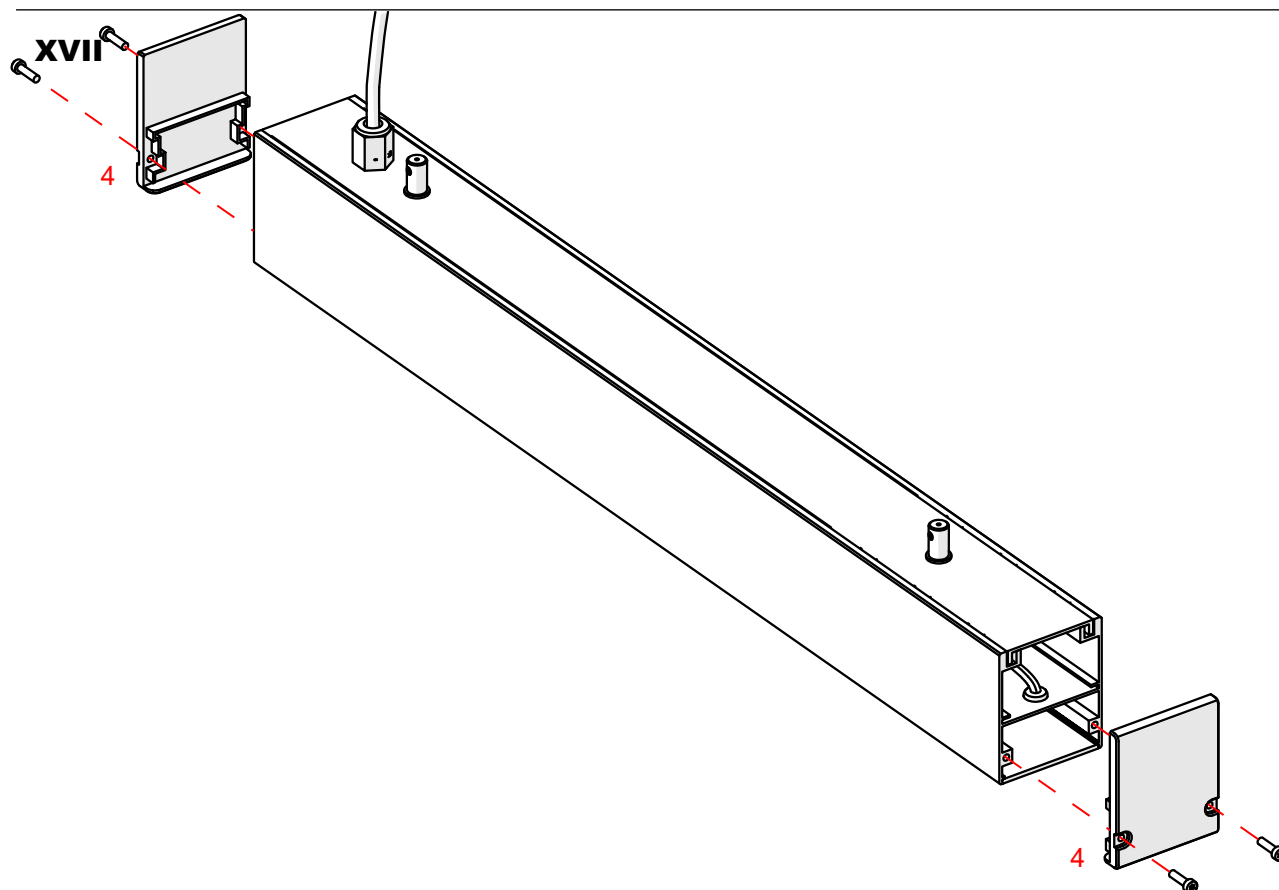

**XVIII**

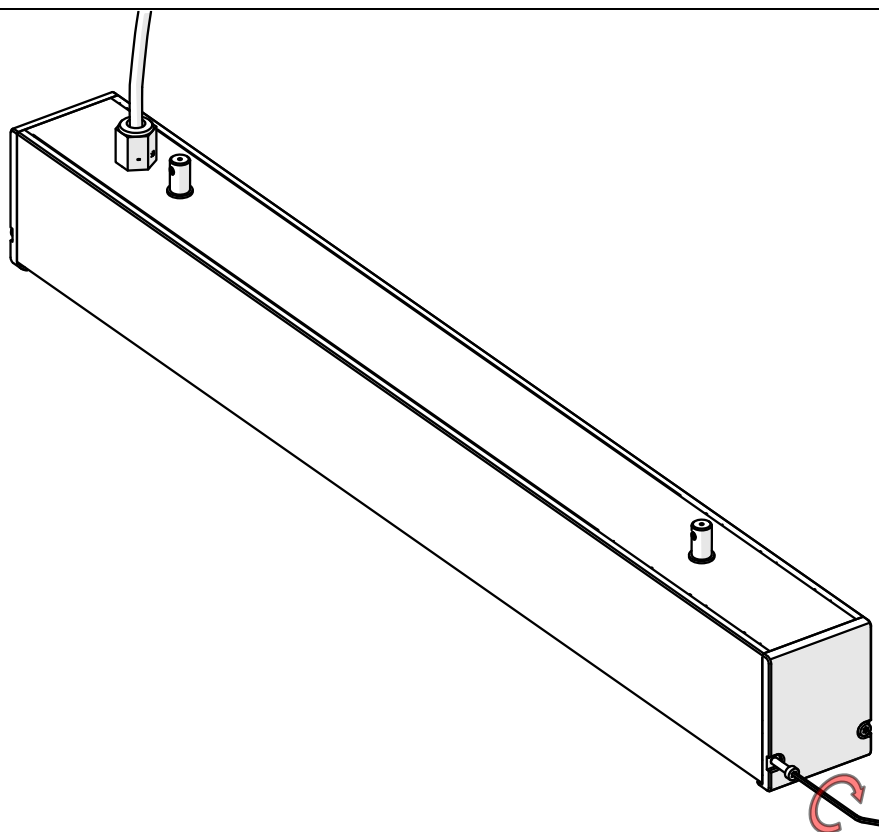

**XIX**

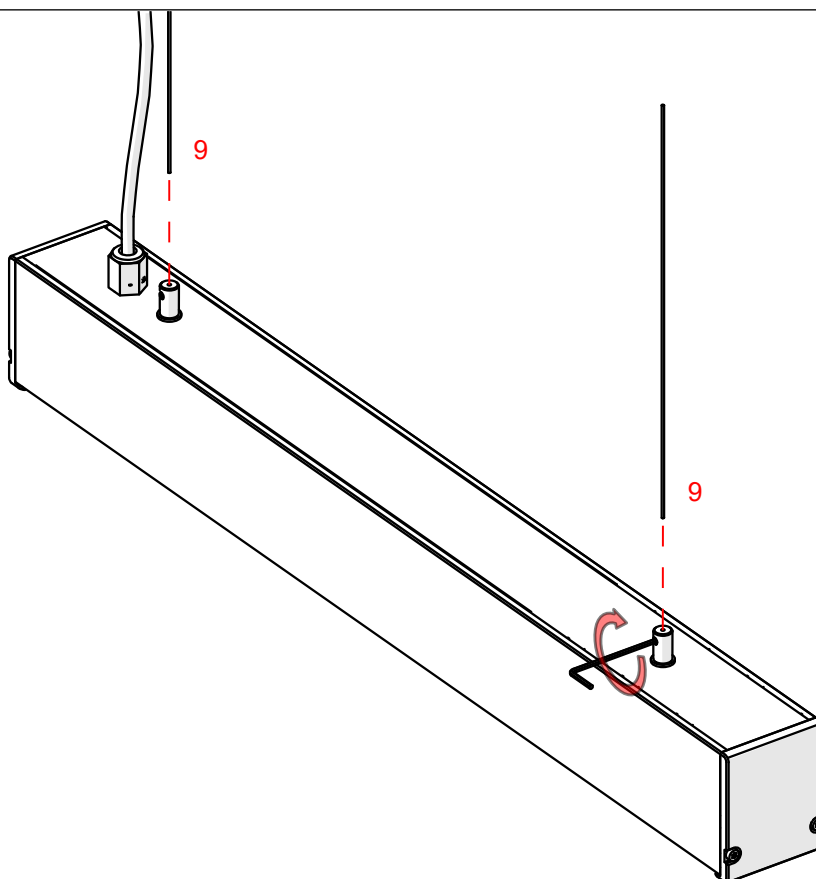

**XX**

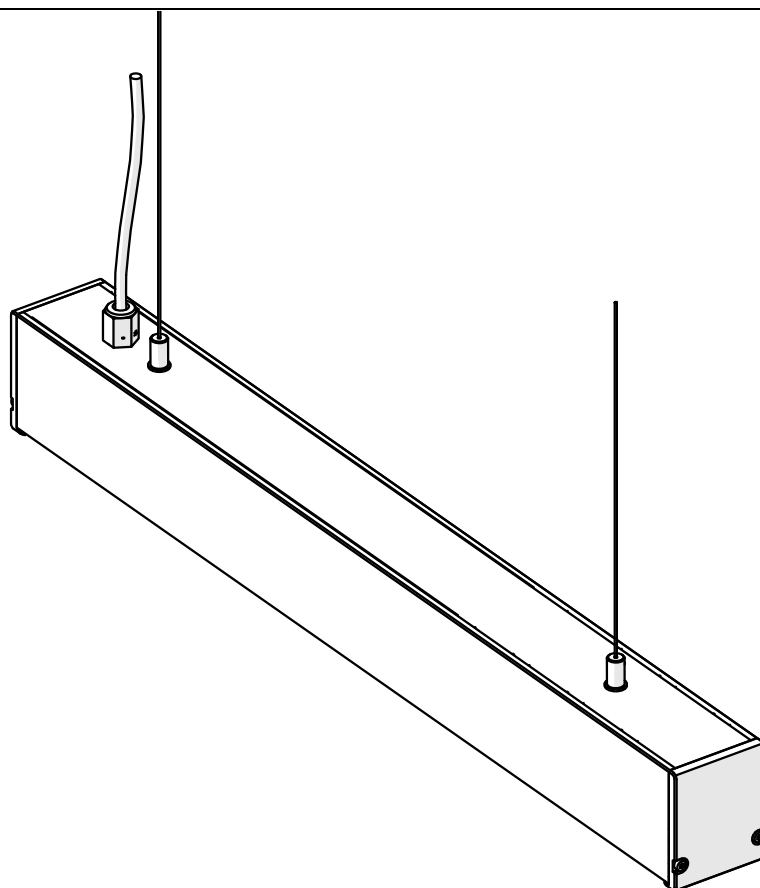

**XXI**

22 0-24 0V AC  
50/60Hz



**XXII**

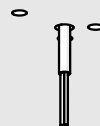
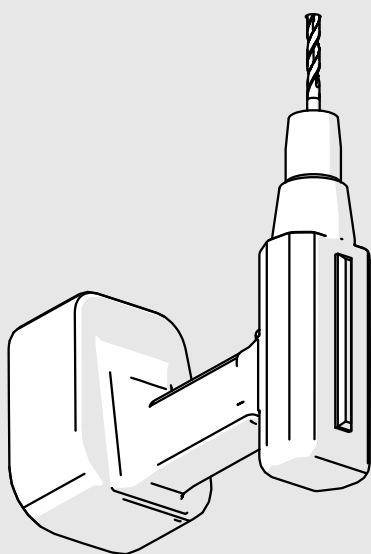

**XXIII**

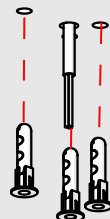
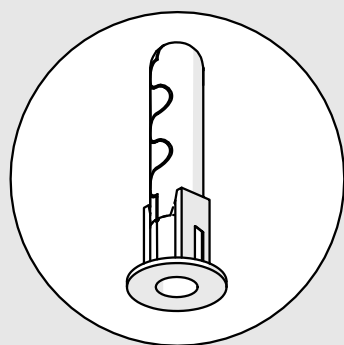

**XXIV**

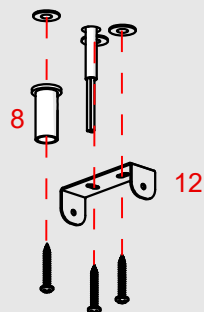
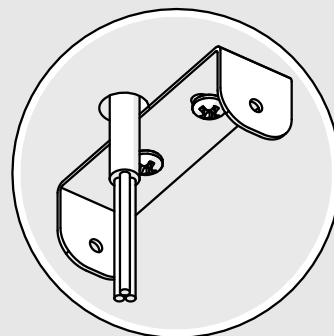

**XXV**

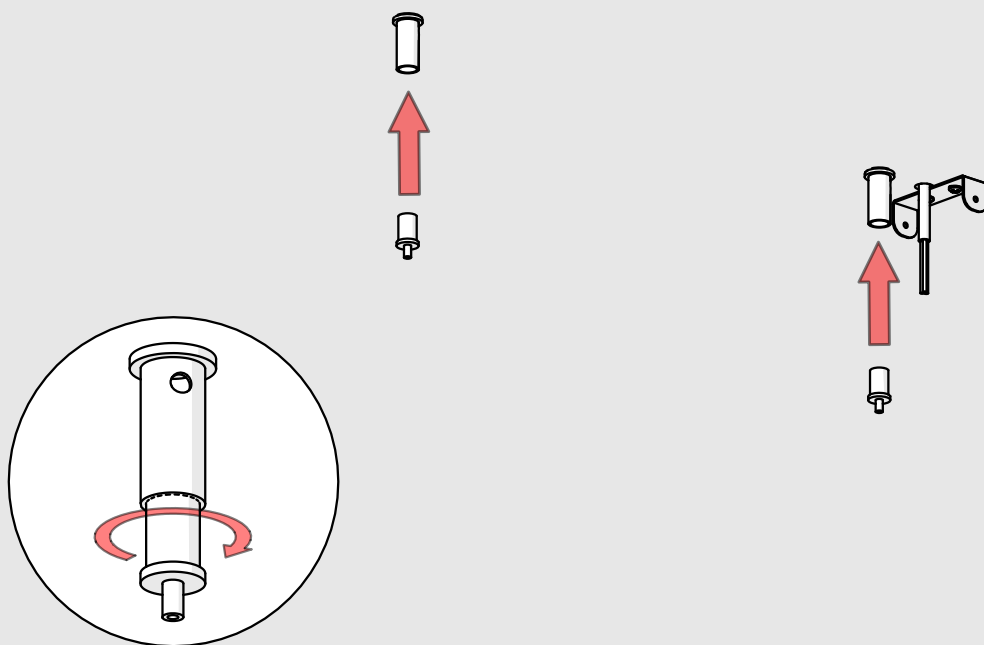

**XXVI**

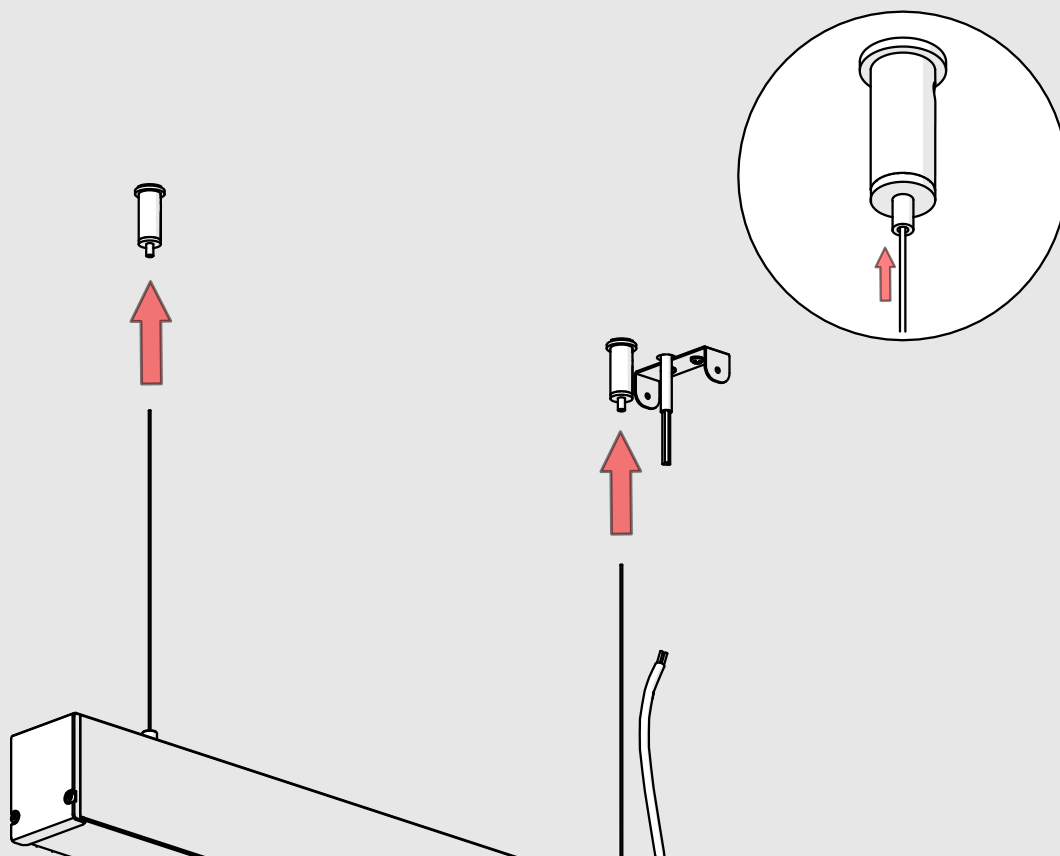

**XXVII**

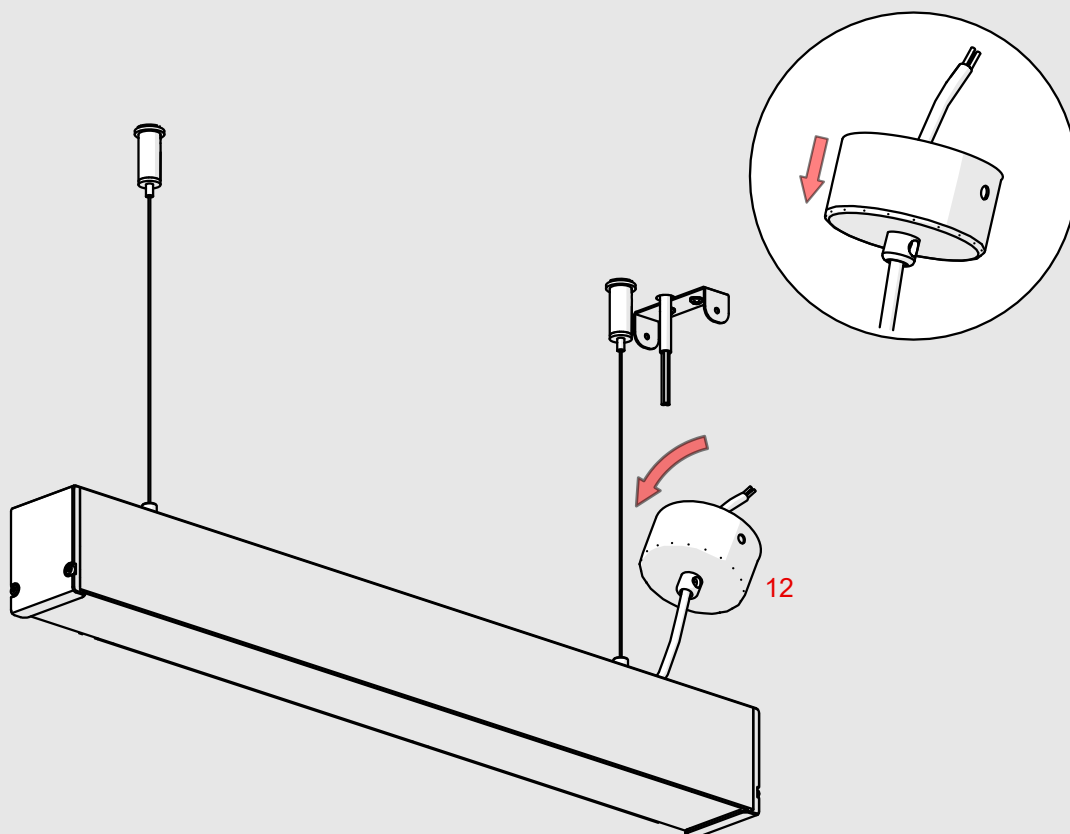

**XXVIII**

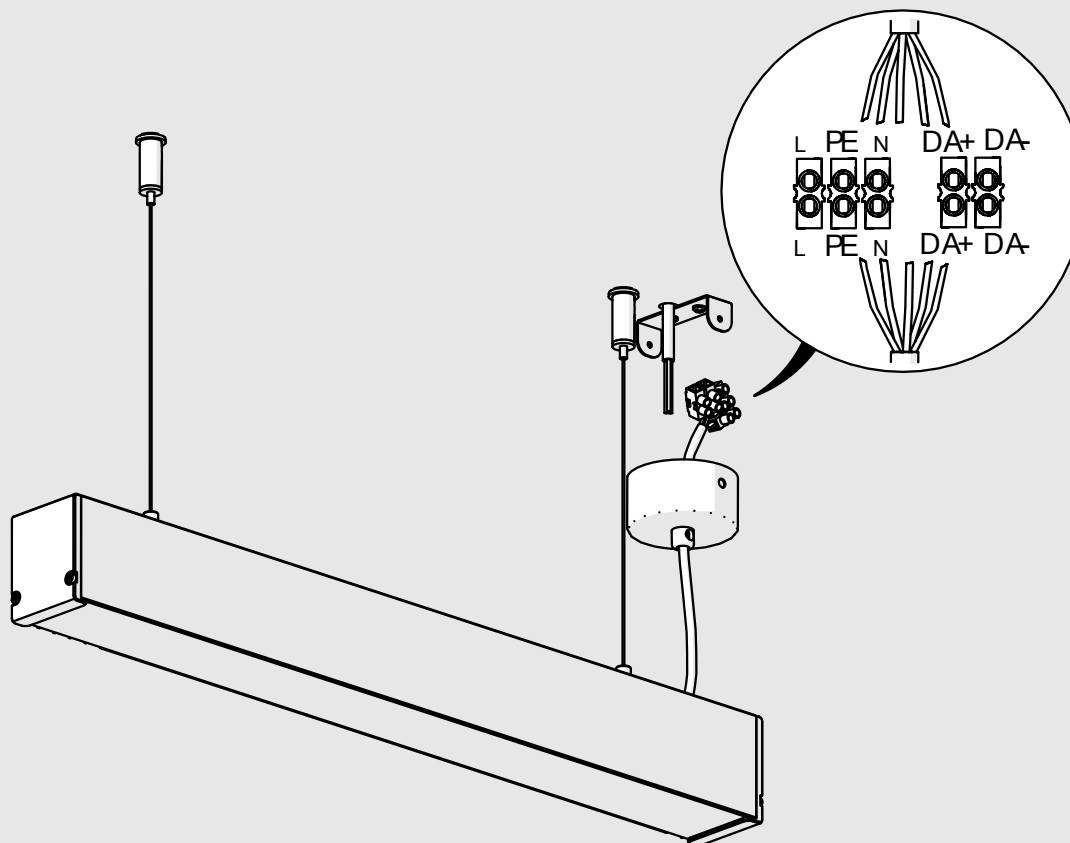



**XXIX**

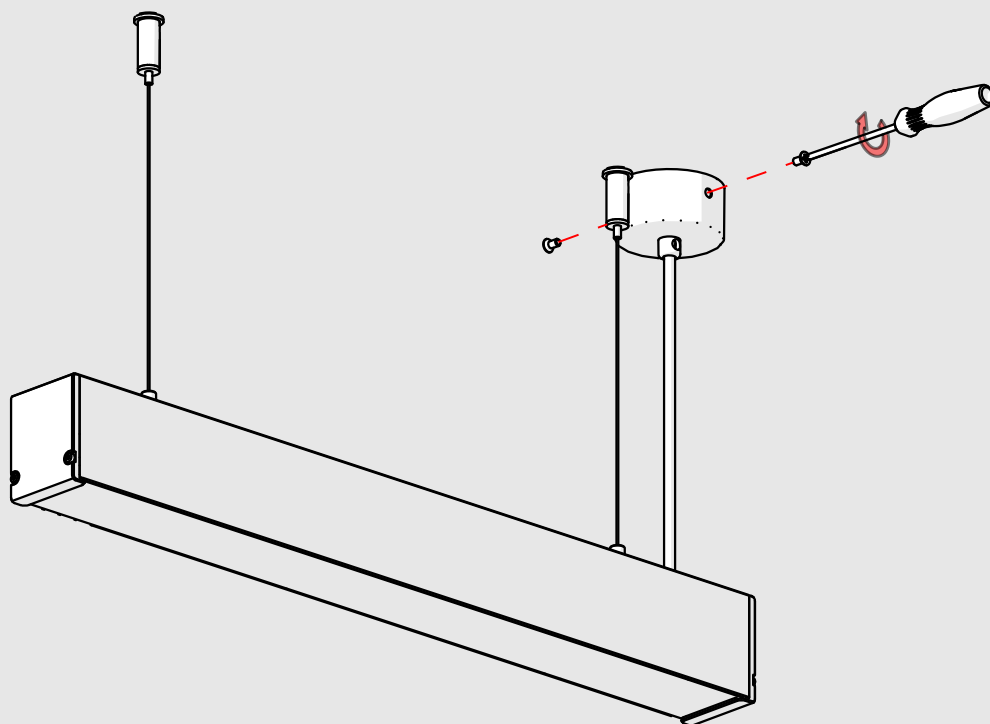

**XXX**

