

Parts needed to mount the DP-MOC-ZO fastener

Head (C)

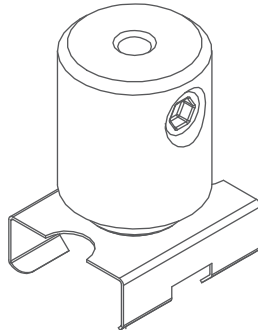

Mounting bracket (B)

Head cable (A)



Tools needed for mounting:

- Allen wrench
- drill

NOTE! A list of products corresponding with the selected accessories is available at www.KlusDesign.eu

1. Drill a hole with a diameter of 5 mm in the selected extrusion.

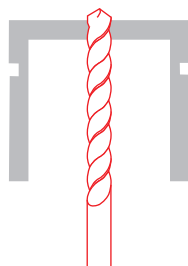

Fi 5 mm

2. Remove the insulation on the section inserted inside the screw and the head. Run the cable (A) through the holes in the mounting bracket (B) and in the head (C). Connect power to the LED strip. Attach the lighting fixture to the mounting bracket.

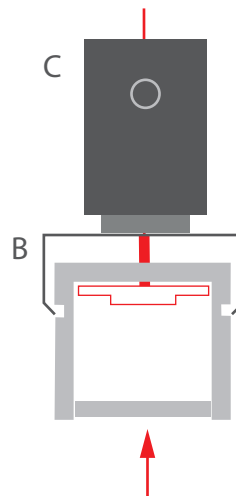

3. Insert the rod into the head (C). It must press the power cable. Block the rod by tightening the pressure screw in the head with the Allen wrench.

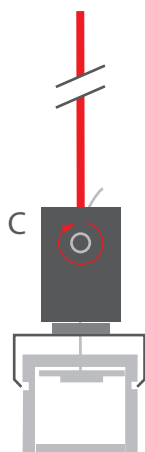

4. Suspend the lighting fixture using a selected suspension and power supply system.

