

1. TICRO-11-RS
2. End cap
3. End cap with a hole
4. LED tape
5. Cover
6. Power supply 12 V or 24 V

NOTE: All LED tapes must be powered by a 12 V or 24 V power supply.
 These instructions do not cover every possible installation method.
 The illustrations of profiles and accessories are simplified and serve only as an approximate representation of the actual product shapes.

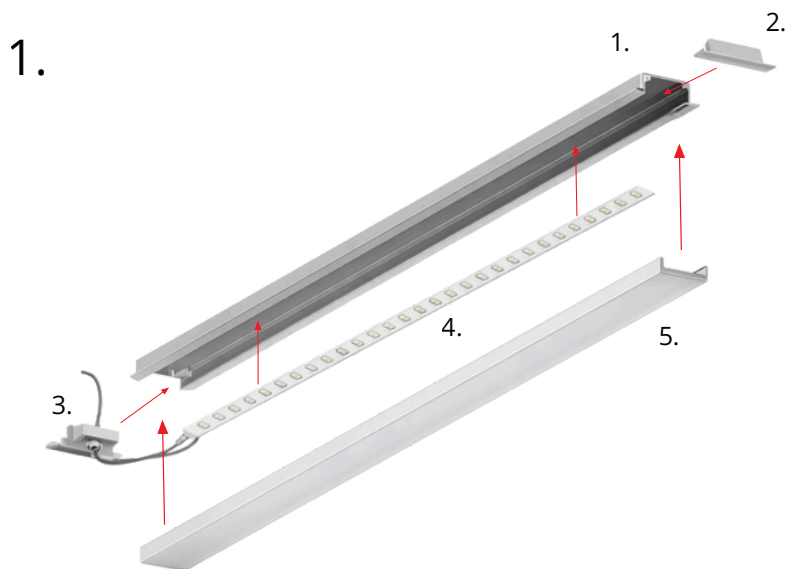

Attach the LED tape (4) to the TICRO-11-RS LED profile (1). Install the cover (5) and the end caps (2,3). Feed the power cable from the LED tape through the opening in the end cap (3).

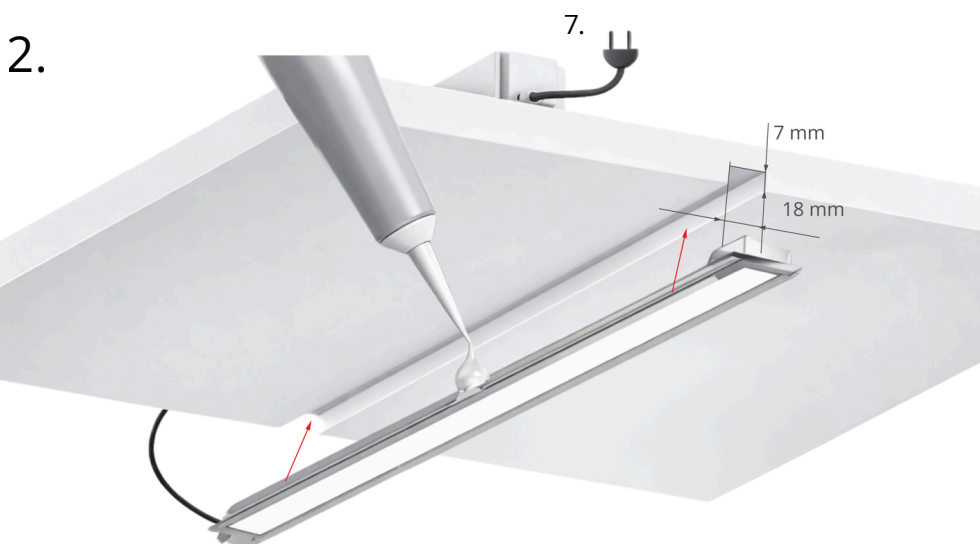

Connect the LED tape cable to the power supply (7). Apply an even layer of adhesive to the back of the extrusion and install the lighting fixture into the channel according to the dimensions shown in the drawing.

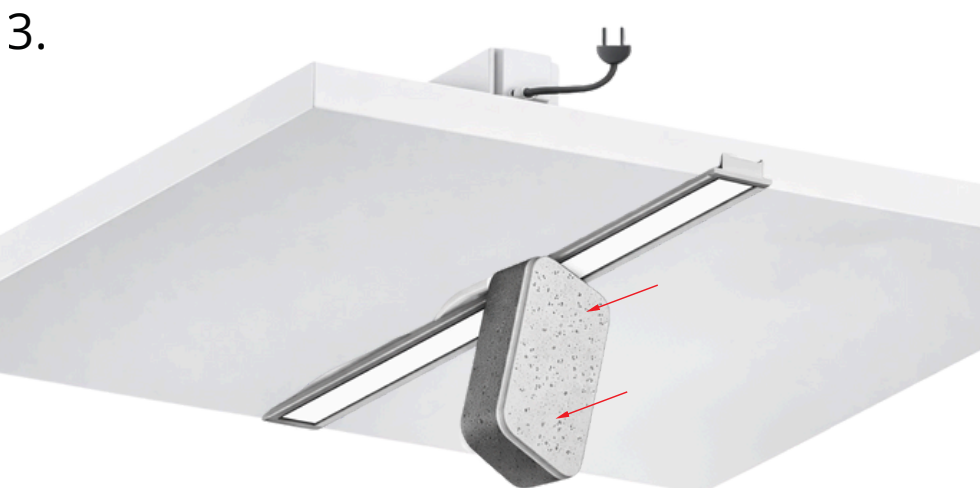

Remove any excess glue from the lighting fixture.